

1 OPEN PLAN OFFICE SPACE

Comfort diffuser with 300lm/ft direct and 500lm/ft indirect and HS2-BA25, 4 heads per 12ft

Room Size:	50'x50'	Workplane 30" above finished floor (fc level)	46
Ceiling height:	10'	Wall Illuminance	43
Luminaire mounting height:	8'5"	Workplane uniformity max to min	1.4 to 1
Reflectances:	80/50/20	Ceiling uniformity maximum to minimum	5.3:1
Light loss factor:	1.0	UGR average	<15
		Watt sq/ft	0.56

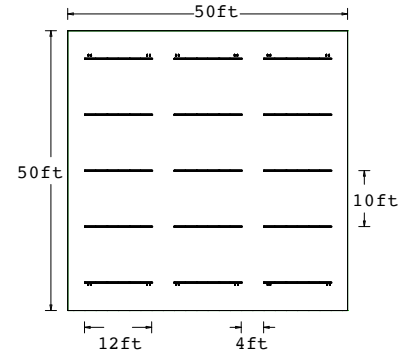

2 SINGLE OFFICE SPACE

Comfort diffuser with 300lm/ft direct and 500lm/ft indirect and HS2-BA42, 2 heads per 8ft

Room Size:	10'x10'	Workplane 30" above finished floor (fc level)	37
Ceiling height:	10'	Wall Illuminance	31
Luminaire mounting height:	8'5"	Ceiling uniformity maximum to minimum	3.5:1
Reflectances:	80/50/20	UGR average	<12
Light loss factor:	1.0	Watt sq/ft	0.81

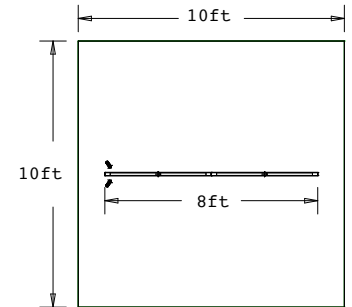

3 CORRIDOR SPACE

Comfort Diffuser with 300lm/ft direct and 300lm/ft indirect and HS2-BA25, 2 heads per 8ft

Room Size:	8'x40'	Workplane 30" above finished floor (fc level)	24
Ceiling height:	10'	Wall Illuminance	29
Luminaire mounting height:	8'5"	Watt sq/ft	0.62
Reflectances:	80/50/20		
Light loss factor:	1.0		

