

FIXTURE COMES PARTIALLY ASSEMBLED.



Ensure electrical circuit is disconnected before installation.



Luminaires must be installed in accordance with national electrical code and local regulation.

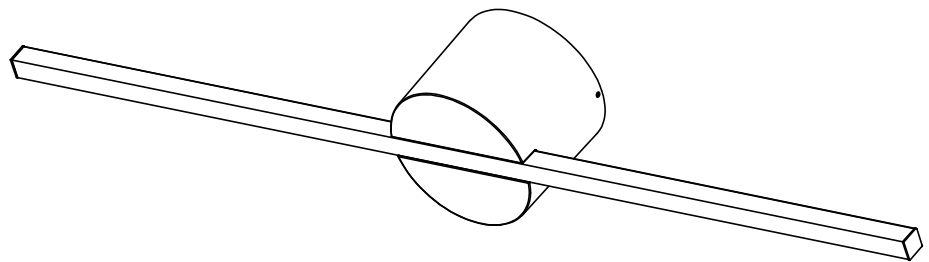

FIG-1

## STEP-1

1. Unfasten the socket set screw from the hub as shown.  
(See Fig-2)

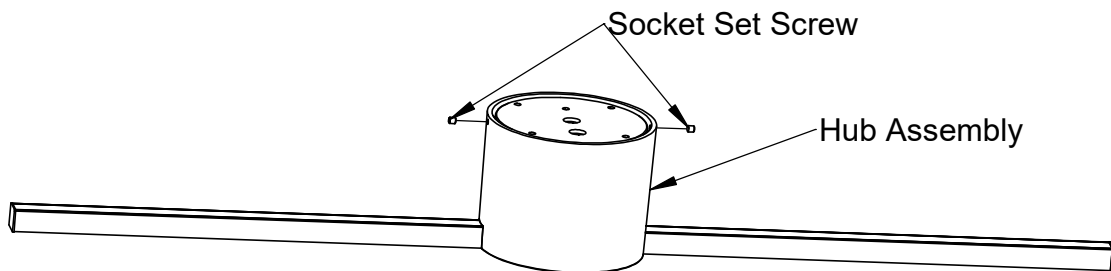
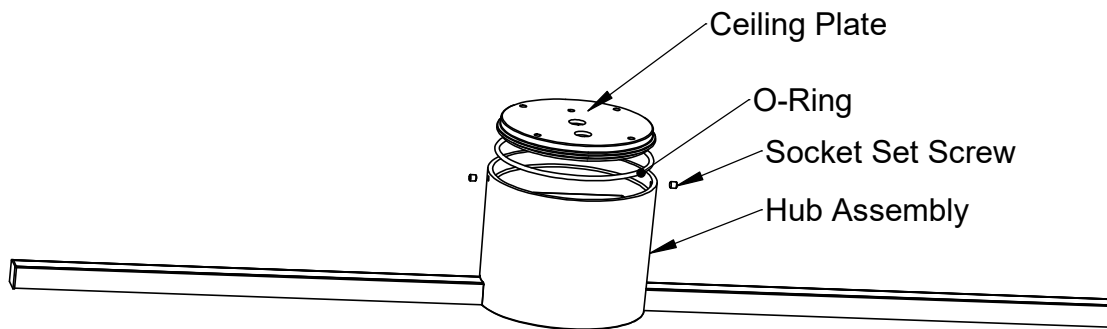

FIG-2

**STEP-2**

1. Separate the ceiling plate from the rest of the fixture (Fig-3).
2. Place the ceiling plate on installation location and align it.

**FIG-3**

## STEP-3

1. Mount the ceiling plate (Fig-4) over the junction box to the ceiling using appropriate fasteners (not included) according to the structure of the ceiling such a way that there is no gap between ceiling and back frame assembly.
2. Make the appropriate electrical connections to the power supply.

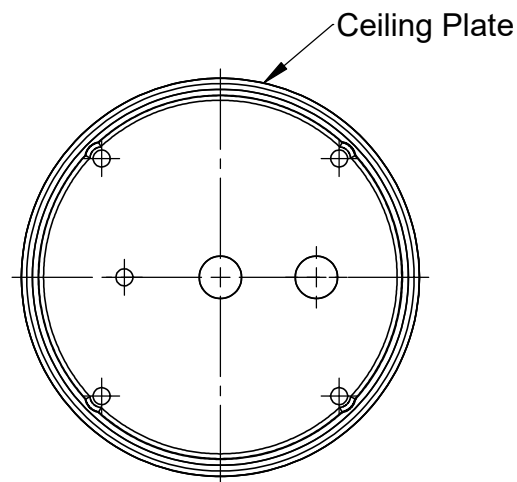

Fig-4

## STEP-4

1. Place back the hub assembly with O-ring over the ceiling plate.
2. Position it on ceiling plate and align it.
3. Re-attach the hub assembly with socket set screws (See Fig-6).

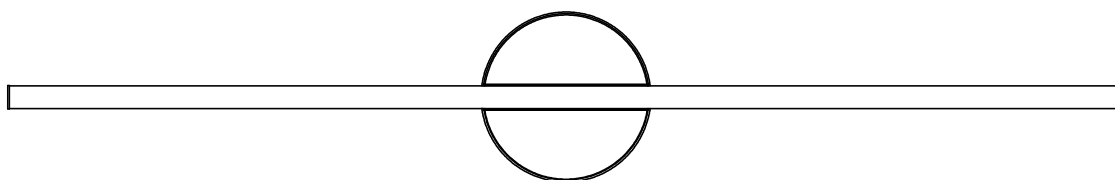

Fig-5

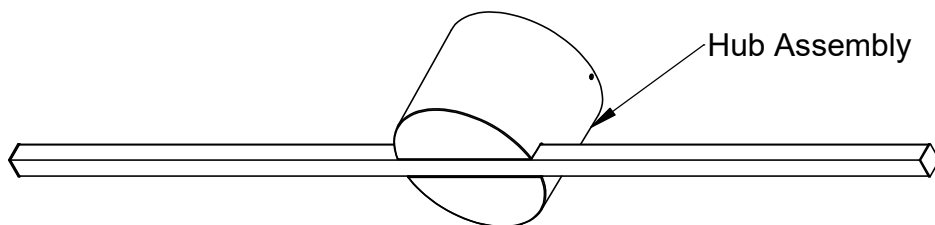

Fig-6