

FIXTURE COMES PARTIALLY ASSEMBLED.



Ensure electrical circuit is disconnected before installation.



Luminaires must be installed in accordance with national electrical code and local regulation.

Wall Installation

1. Fasten the wall bracket to the wall using appropriate fasteners (not included) in accordance with the structure of the wall.

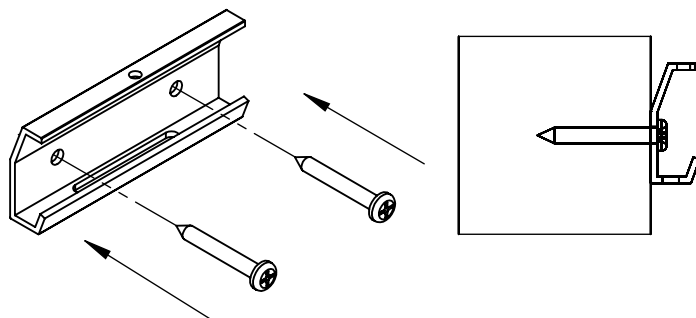

2. Make appropriate wiring connections between fixture and power box.

3. Mount junction box cover using appropriate fasteners (not included).

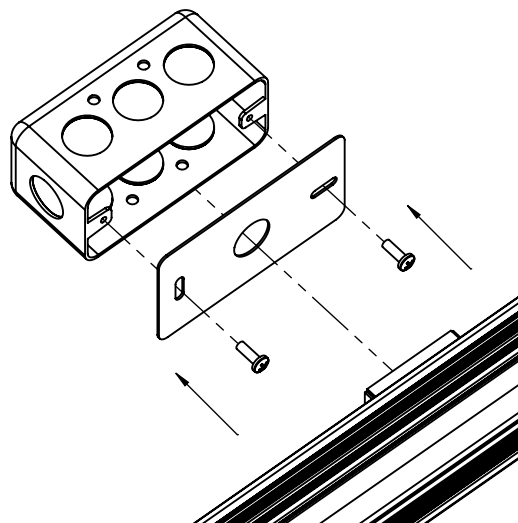

4. Install fixture into the wall bracket and secure in position using the provided screws.

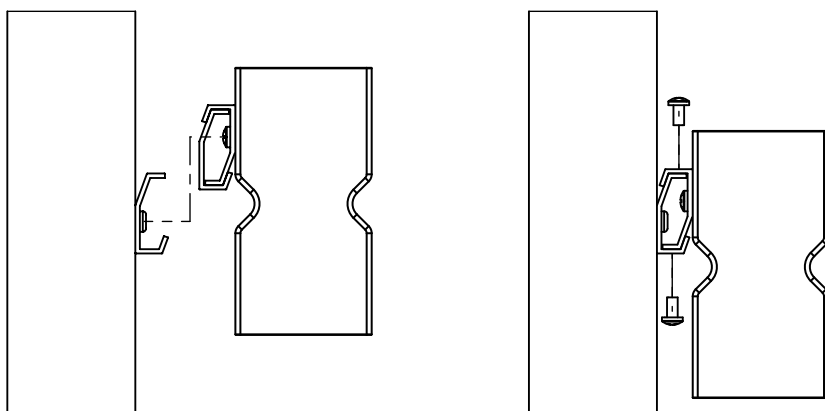

Continuous Installation

5. Remove screws and store for later use, slide plate away from the end of the fixture.

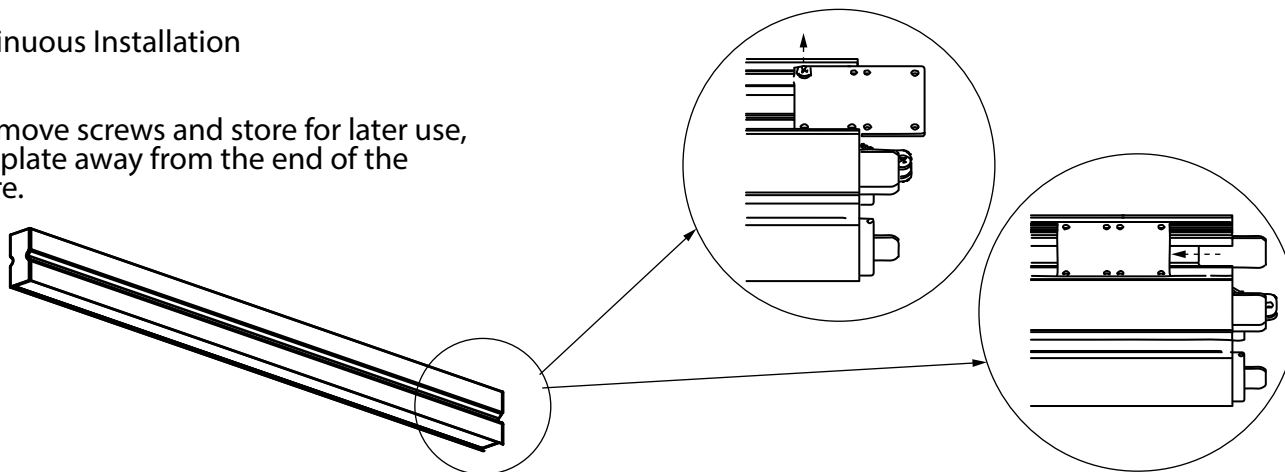

6. If they are not pre-installed, install light leak tabs by sliding them into the end of the fixture on the outside of the alignment plate.

7. Connect to the previous segment by sliding the segments together. Align and secure the connection part to the next fuxture using the provided screws. Connect the two segments together by fastening the nut on the first fixture.

8. Connect electrical connectors at junction between sections.

9. Slide the plate moved in step 5 back so it's centered over the connection between segments, secure with provided screws.

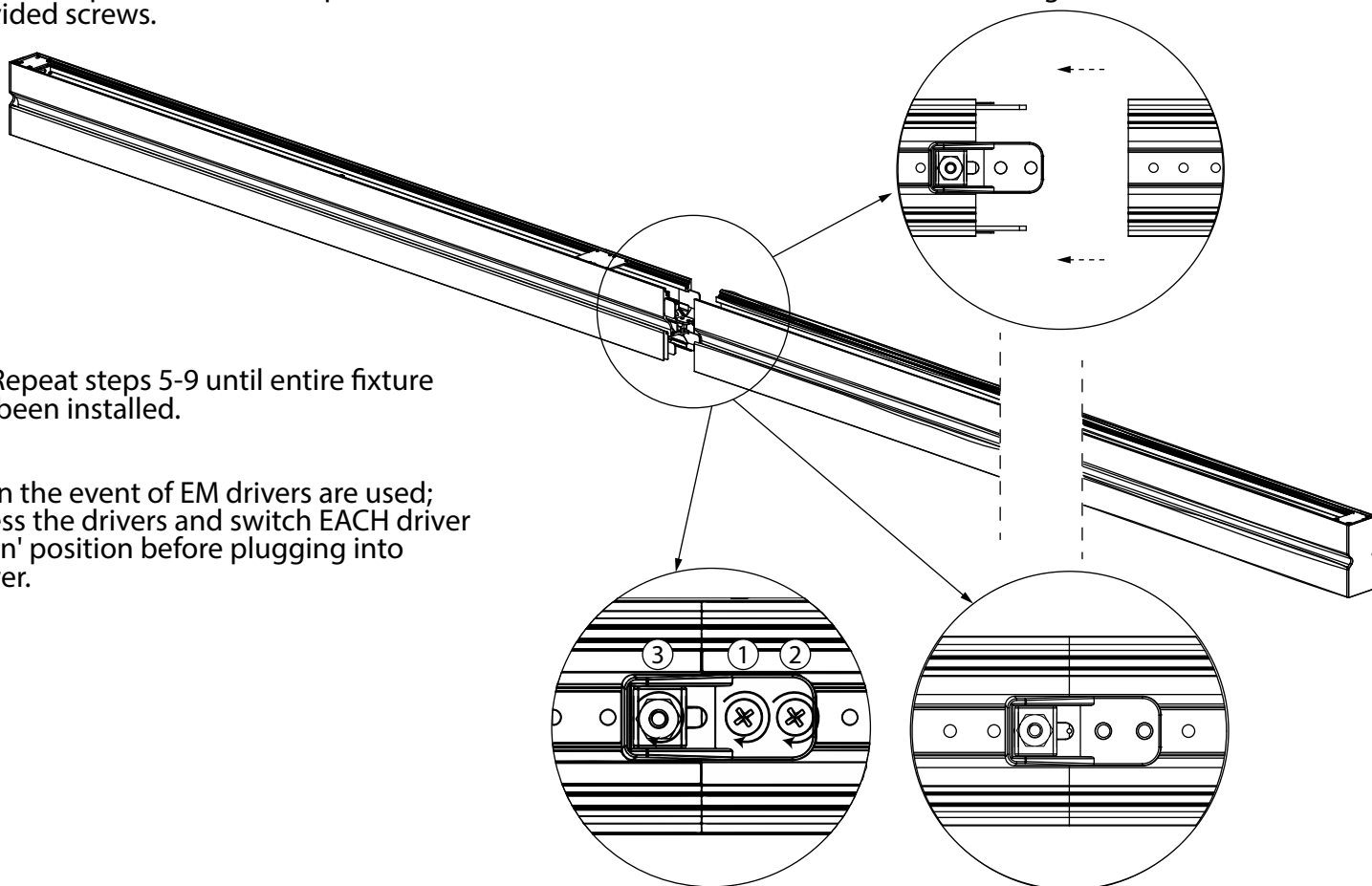

10. Repeat steps 5-9 until entire fixture has been installed.

11. In the event of EM drivers are used; access the drivers and switch EACH driver to 'on' position before plugging into power.