

Cylinder EX™ - Dimensional Diagrams

6" - Full Size Classic Wall Mount Direct-Indirect Only

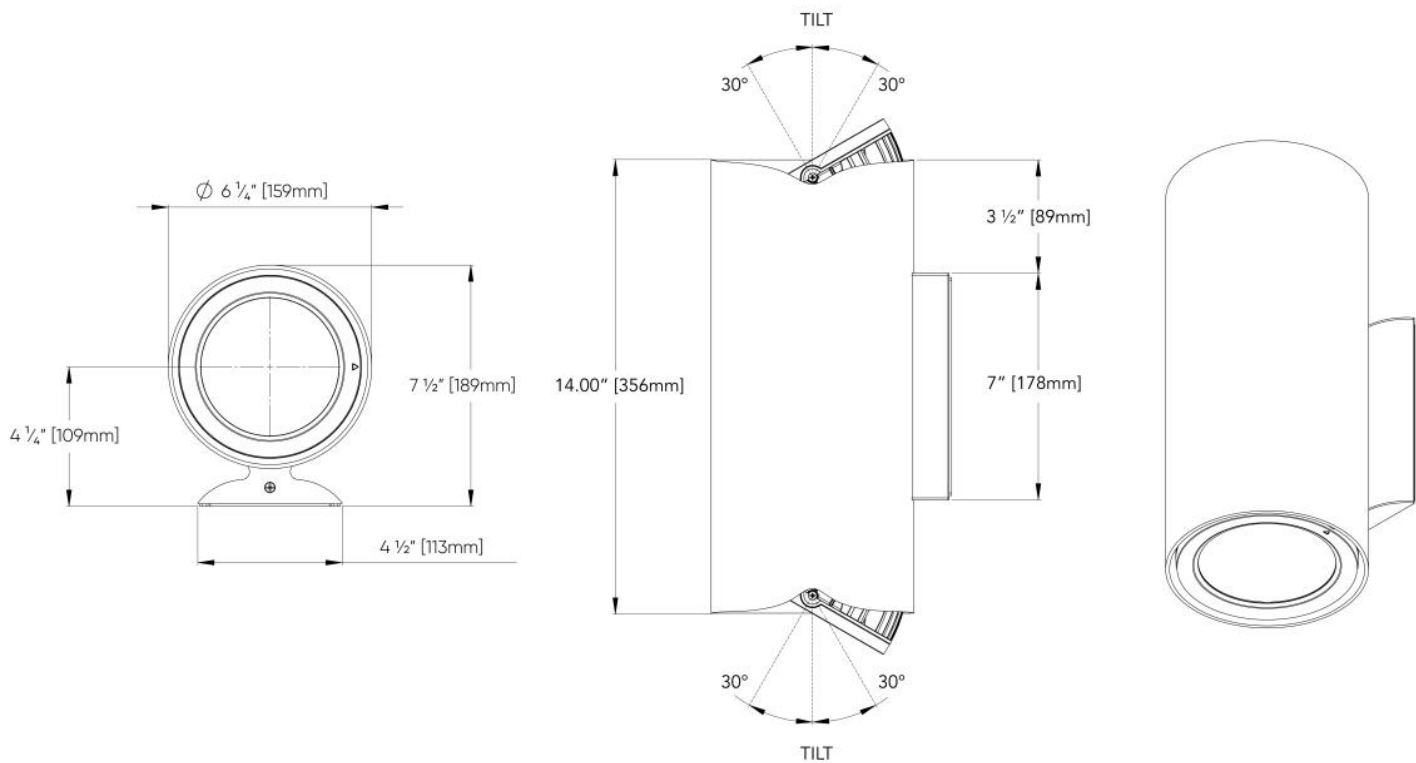

6" - Classic Wall Mount Direct or Indirect only

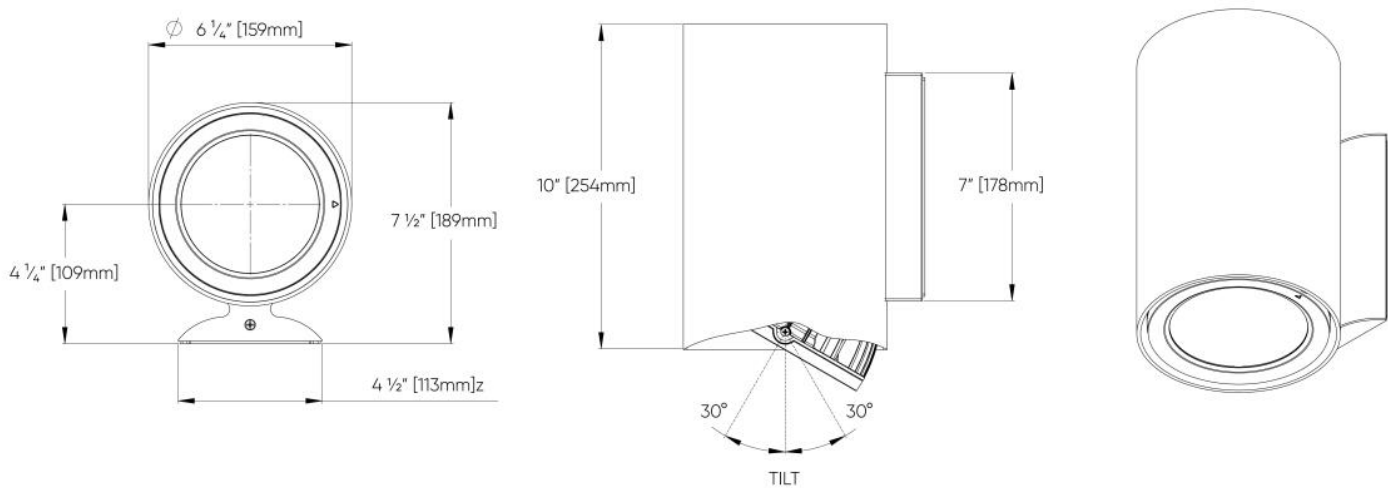

Cylinder EX™ - Dimensional Diagrams

6"- Full Size Short Narrow Wall Mount Direct-Indirect Only

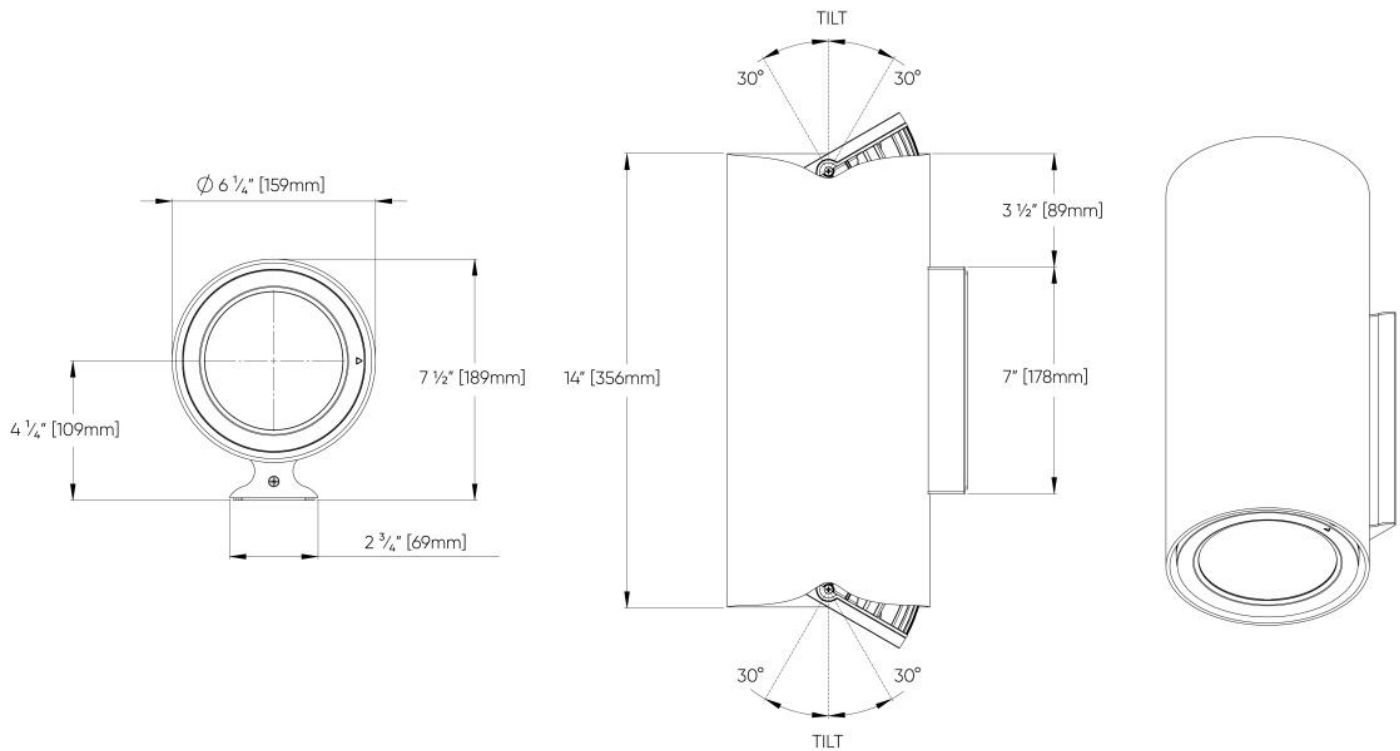

6"- Narrow Wall Mount Direct/Indirect Only

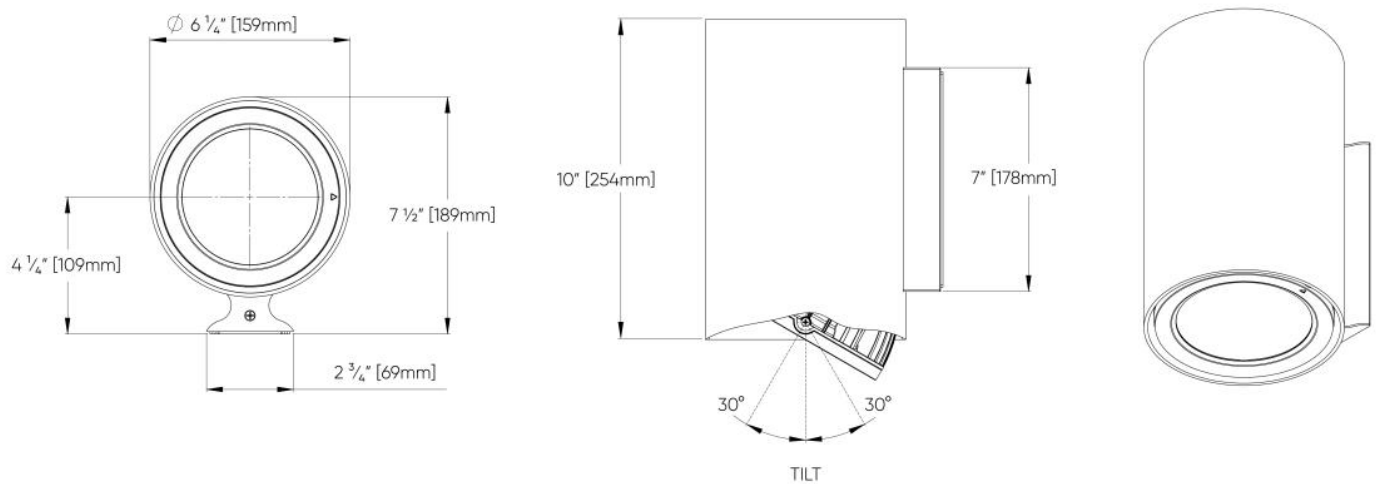

Cylinder EX™ - Dimensional Diagrams

6"- Full Size Tall Narrow Wall Mount Direct-Indirect

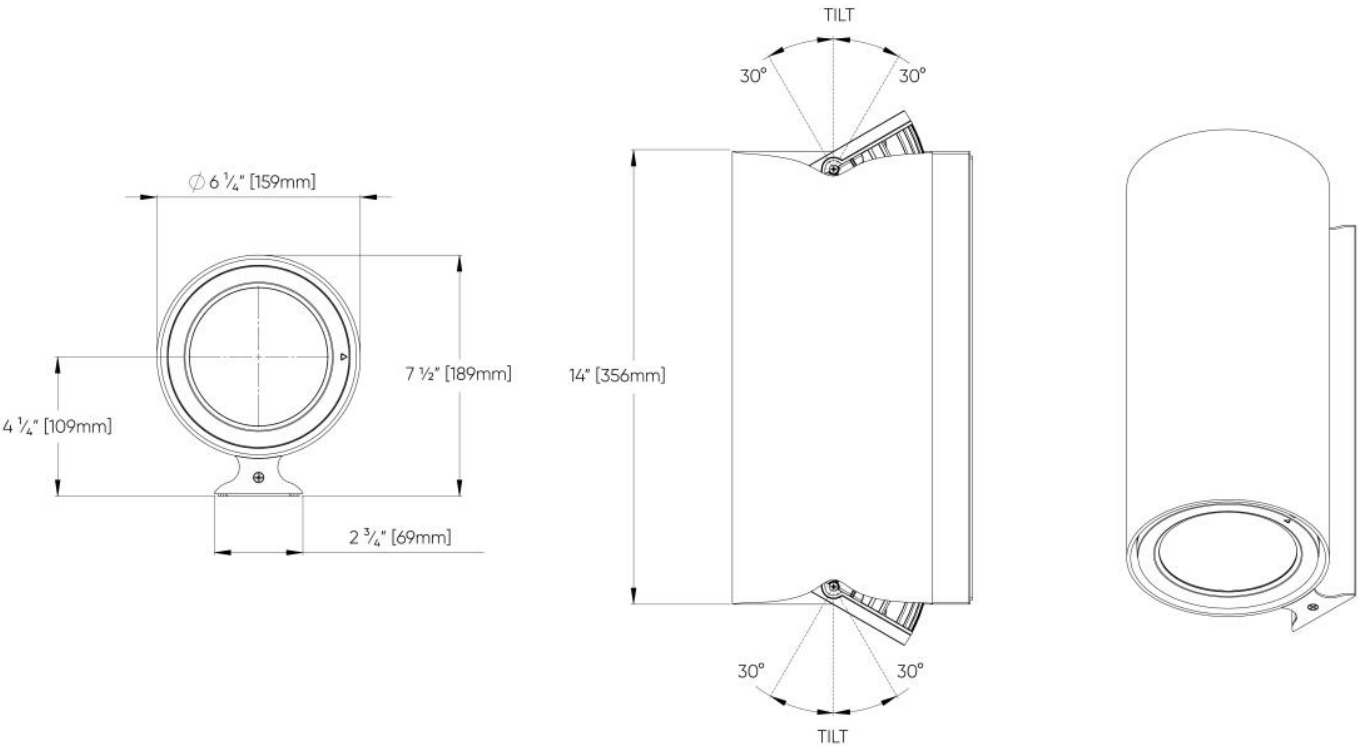

6"- Half Size Narrow full Wall Mount Direct Only

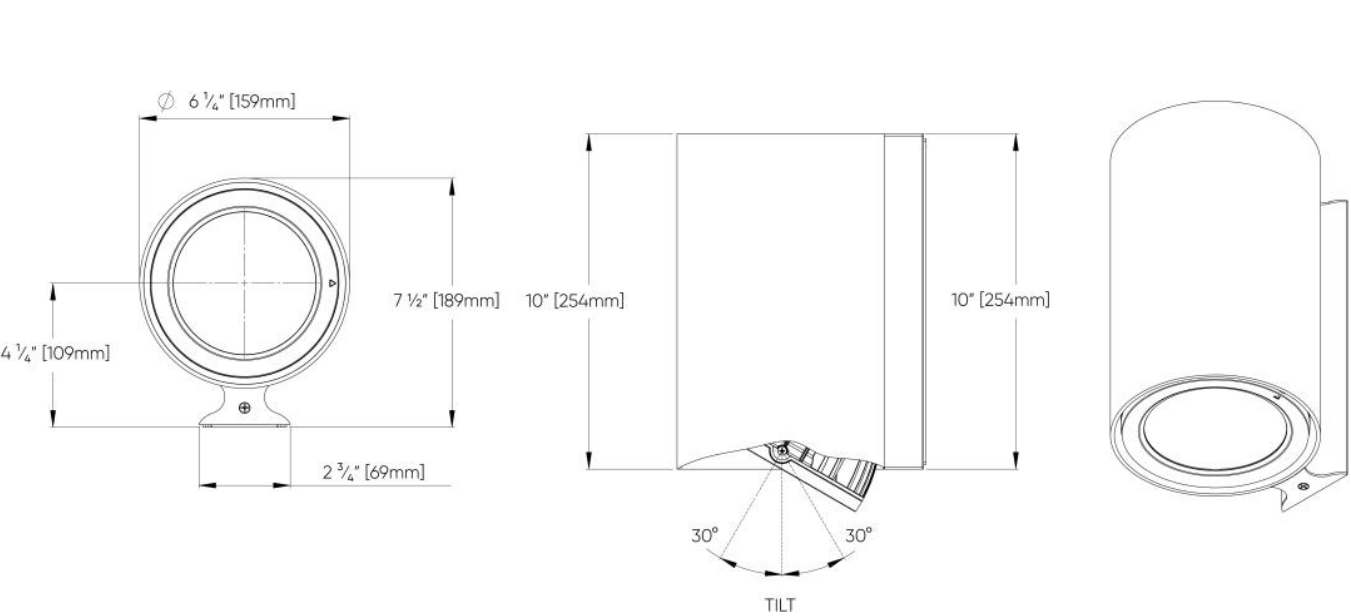

Cylinder EX™ - Dimensional Diagrams

6" - Ceiling Surface Mount Direct Only

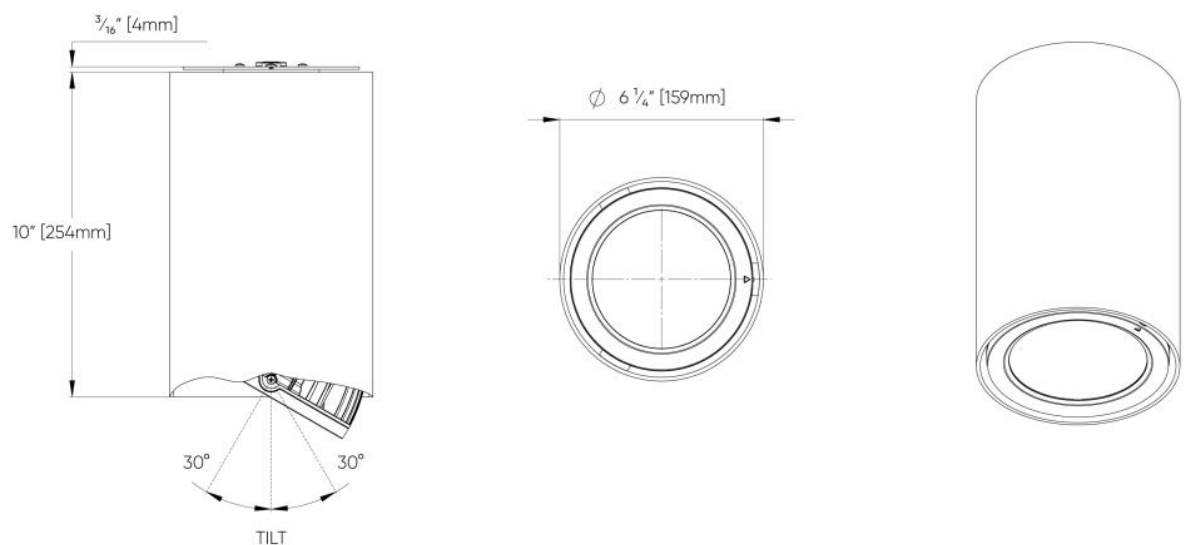

6" - Pendant Stem Mount Direct Only

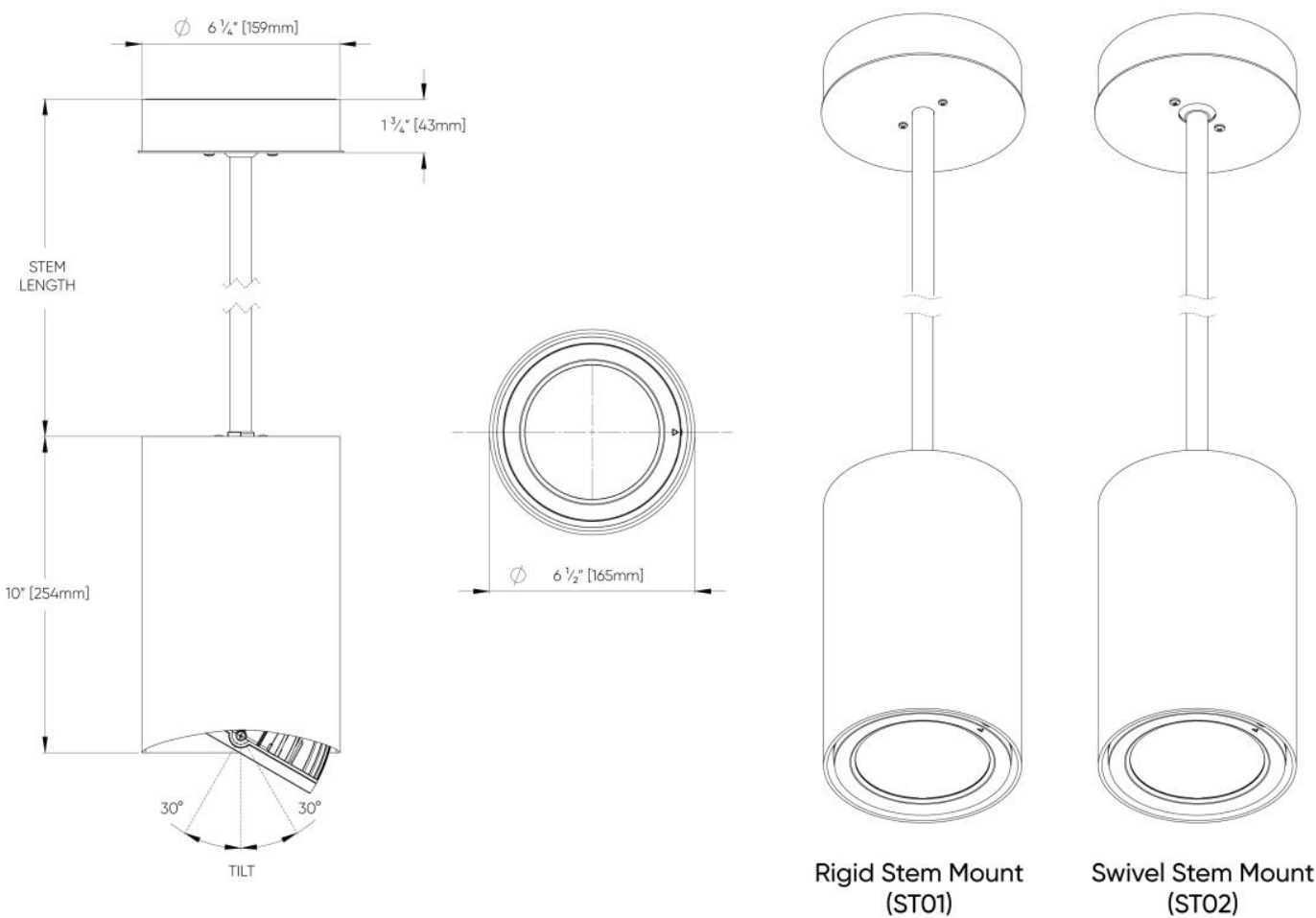

Cylinder EX™ - Dimensional Diagrams

4" - Standard Classic Wall Mount Direct Only

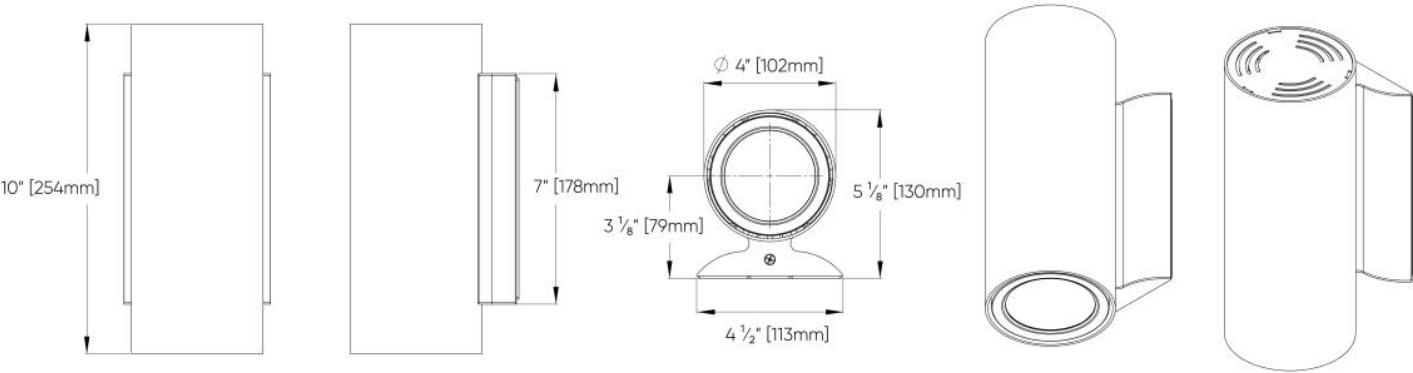

4" - Standard Classic Wall Mount Direct-Indirect Only

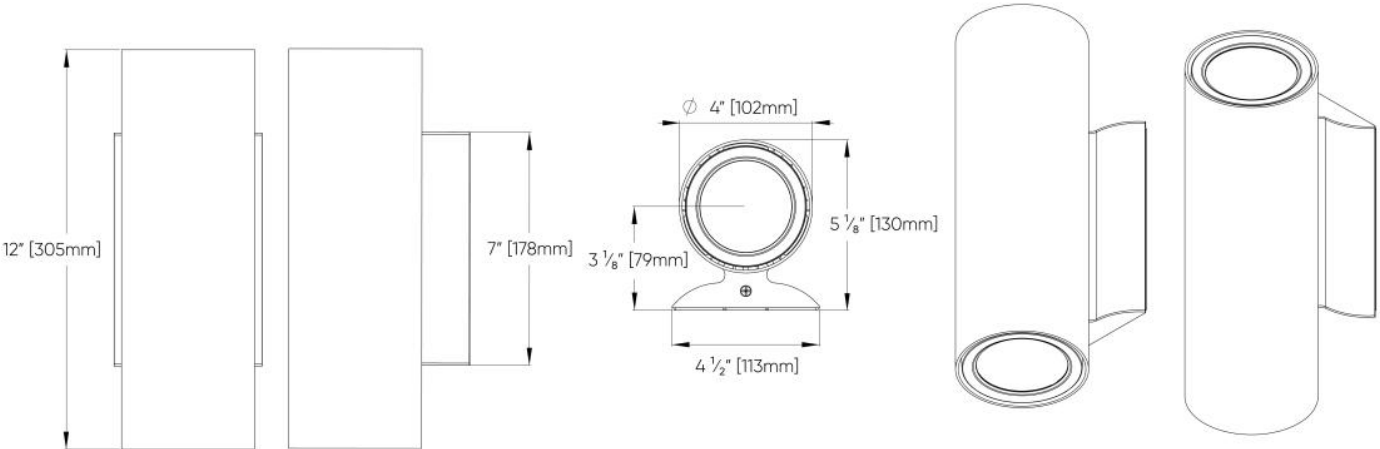

Cylinder EX™ - Dimensional Diagrams

4" - Standard Narrow Wall Mount Direct Only

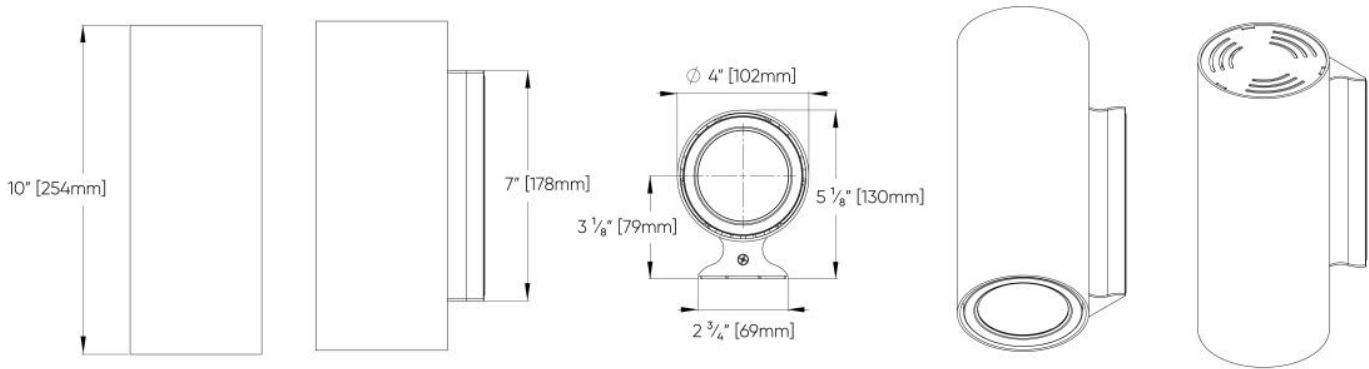

4" - Standard Narrow Wall Mount Direct-Indirect Only

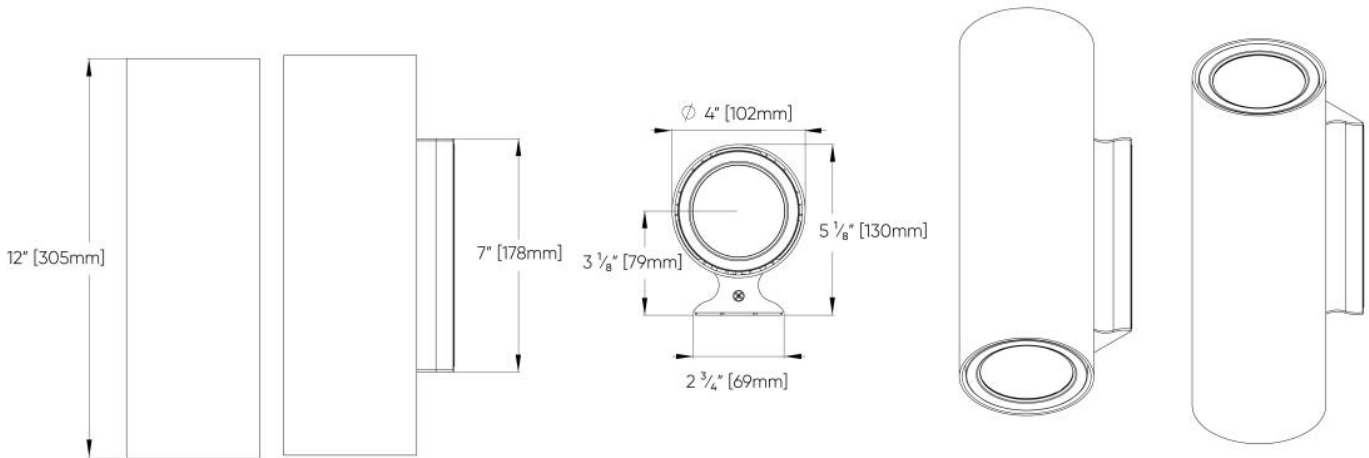

Cylinder EX™ - Dimensional Diagrams

4" - Full Size Narrow Wall Mount Direct Only

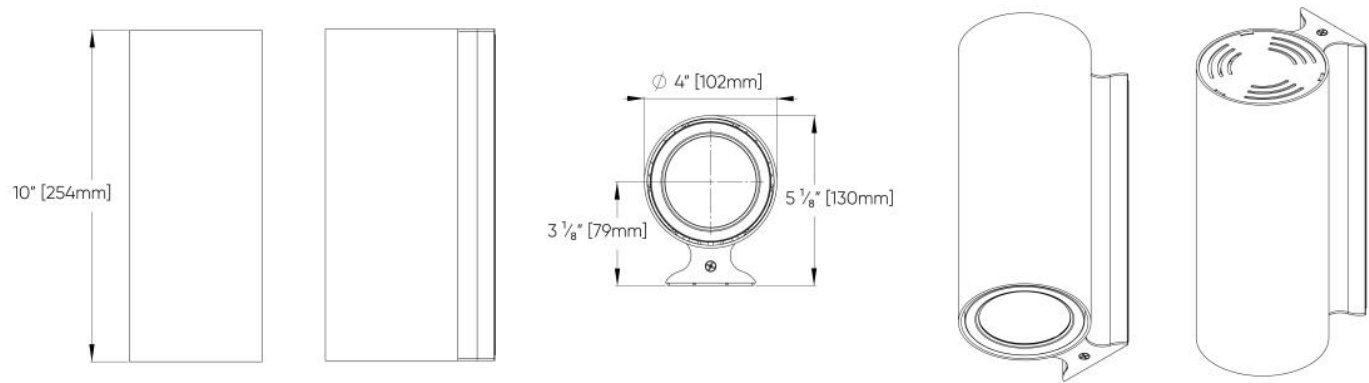

4" - Full Size Narrow Wall Mount Direct-Indirect Only

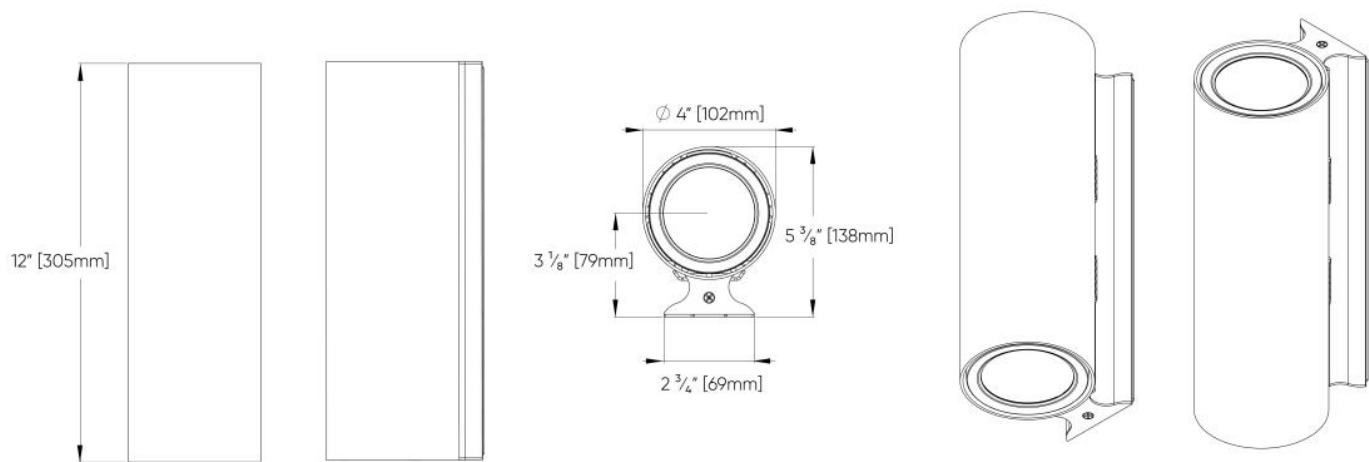

Cylinder EX™ - Dimensional Diagrams

4" - Pendent Rigid Stem Mount Direct Only

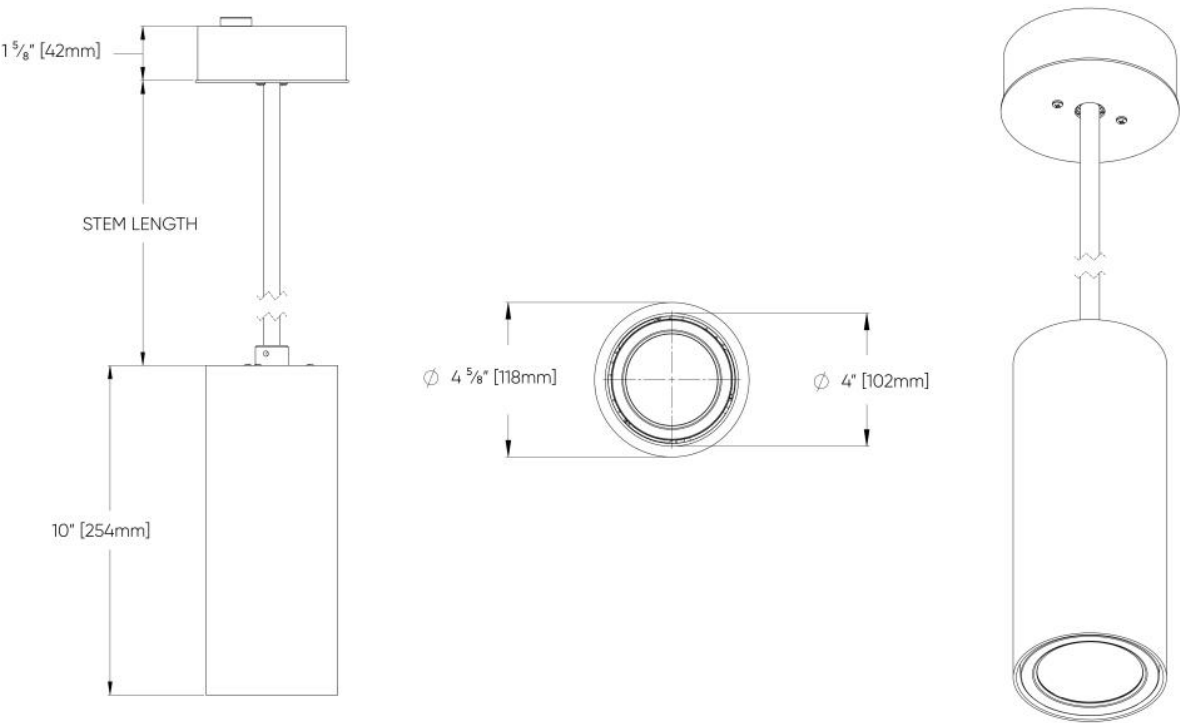

4" - Pendent Swivel Stem Mount Direct Only

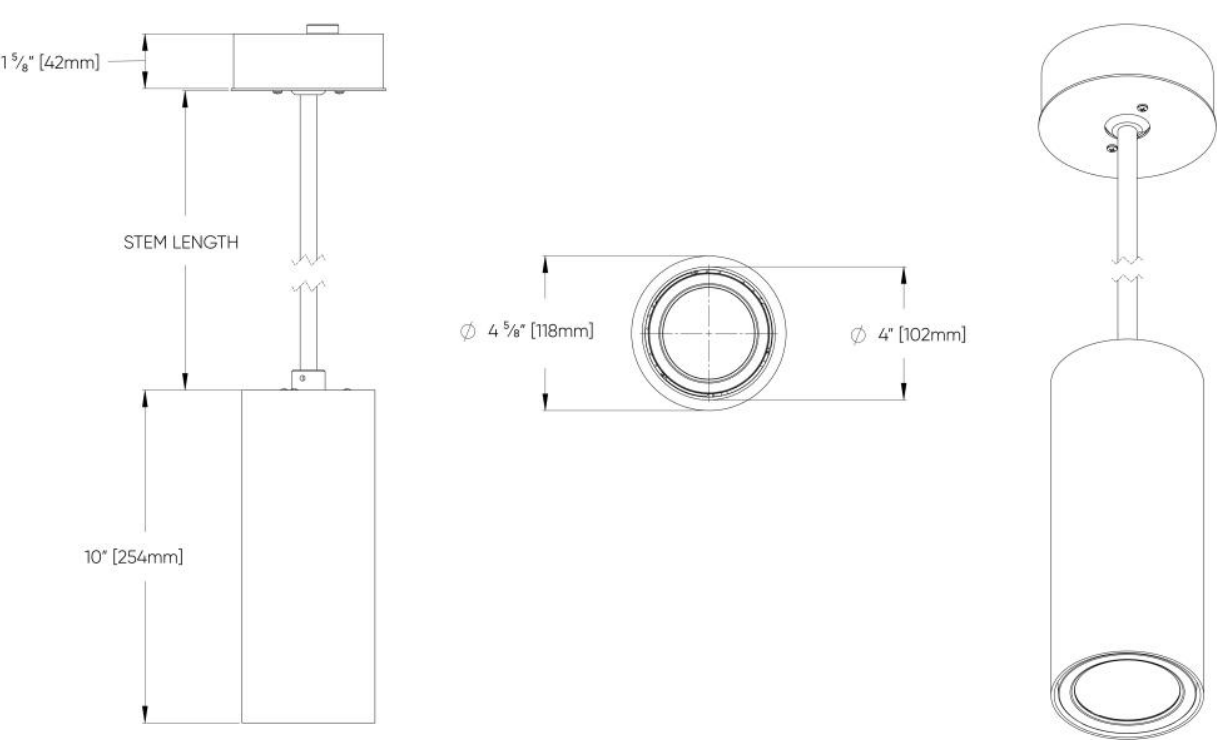

Cylinder EX™ - Dimensional Diagrams

4" - Ceiling Mount Direct Only

