

Hard ceiling canopy

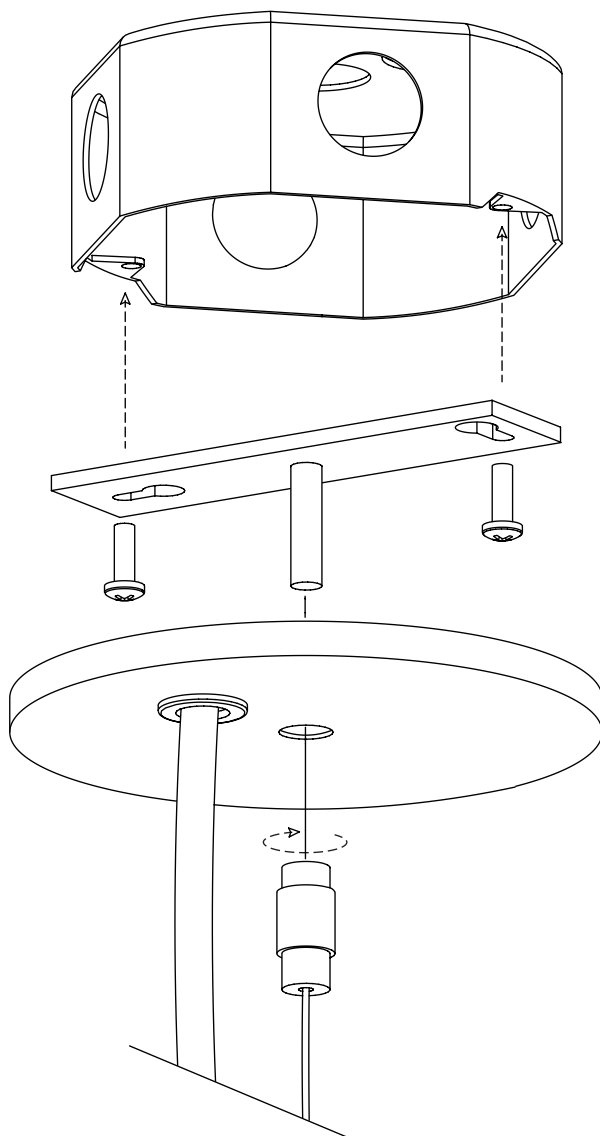

Hard ceiling cable coupler kit

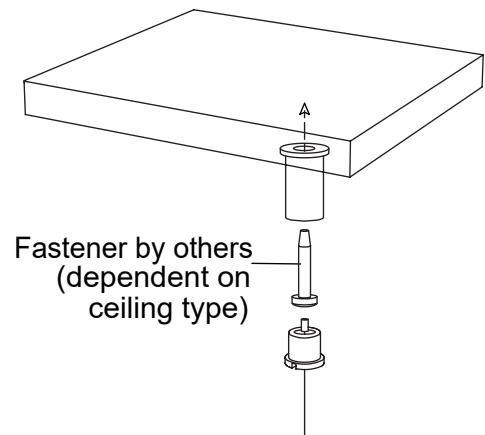

Aircraft cable

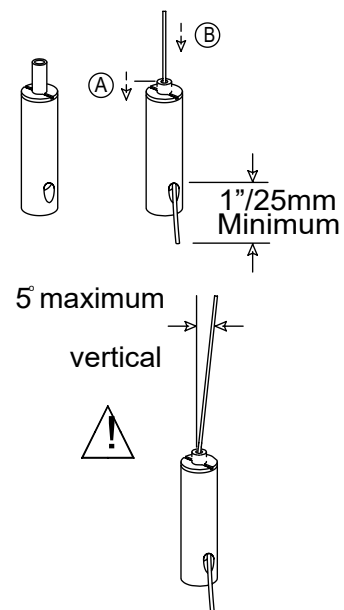

T-Bar ceiling cable coupler kit

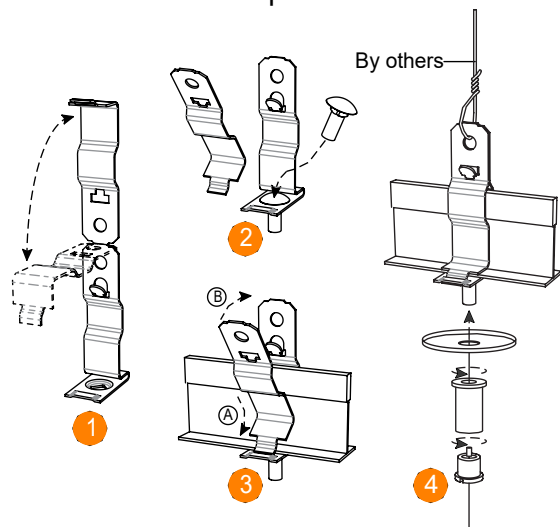

Suspended ceiling cable coupler kit

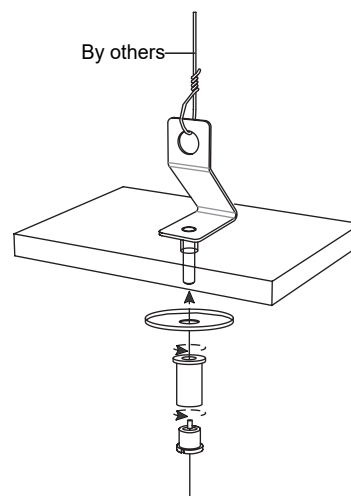

Aircraft cable

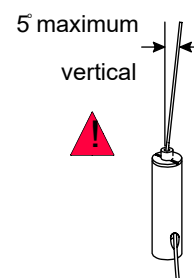
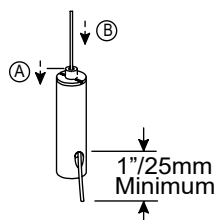

T-Bar ceiling canopy

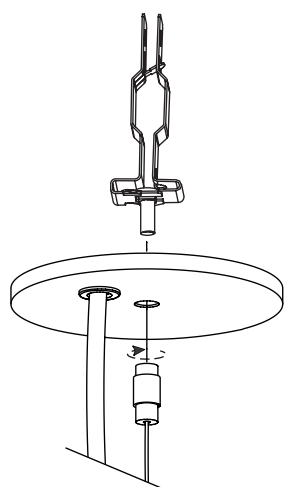

Suspended ceiling canopy

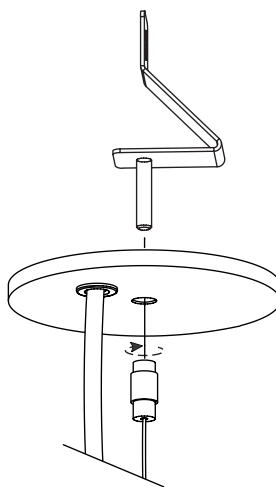

Plenum Ceiling

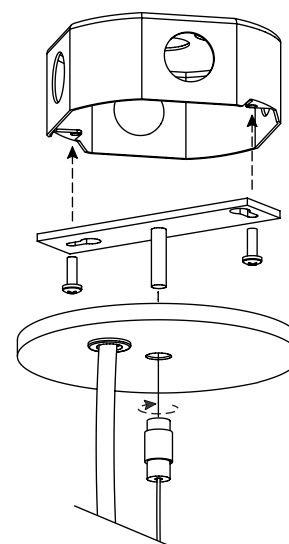

FIXTURE COMES PARTIALLY ASSEMBLED.



Ensure electrical circuit is disconnected before installation.



Luminaires must be installed in accordance with national electrical code and local regulation.

1: Start by the section with the power cord. (see Fig. 1). Refere to the Aircraft Cable Suspension instructions based on the ceiling type and make all appropriate ceiling connections.

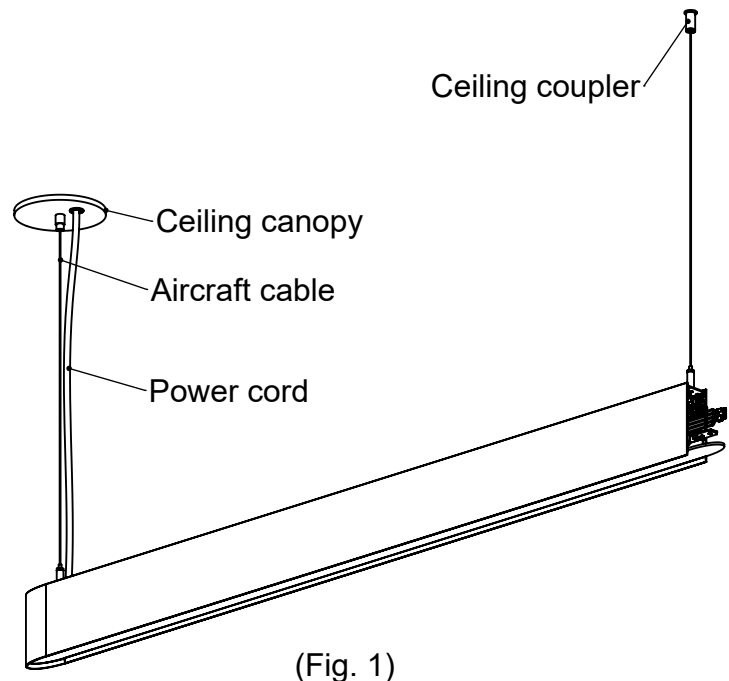

(Fig. 1)

2: The suspension plate (the side without the power cord) can be adjusted by unscrewing the two set screws and sliding along the frame channel. After adjusting to a suitable position, tighten the two set screws to lock the position (see Fig. 2).

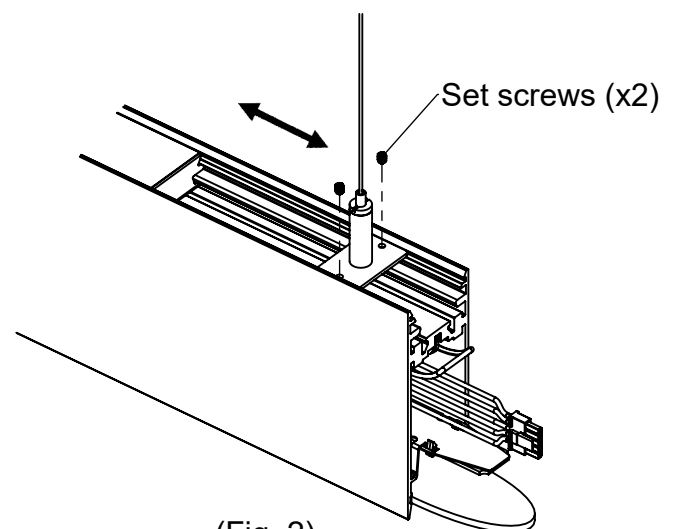

(Fig. 2)

FIXTURE COMES PARTIALLY ASSEMBLED.



Ensure electrical circuit is disconnected before installation.



Luminaires must be installed in accordance with national electrical code and local regulation.

3: Remove the lens and pull down the LED gear tray (see Fig. 3).

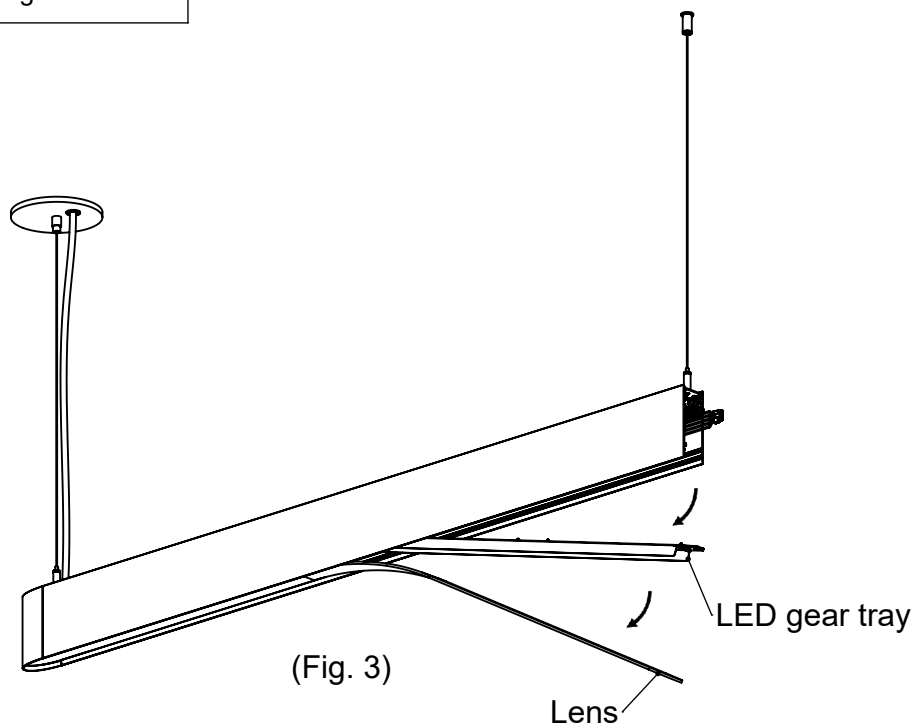

4. Attach the flexible joiner (see Fig. 4).

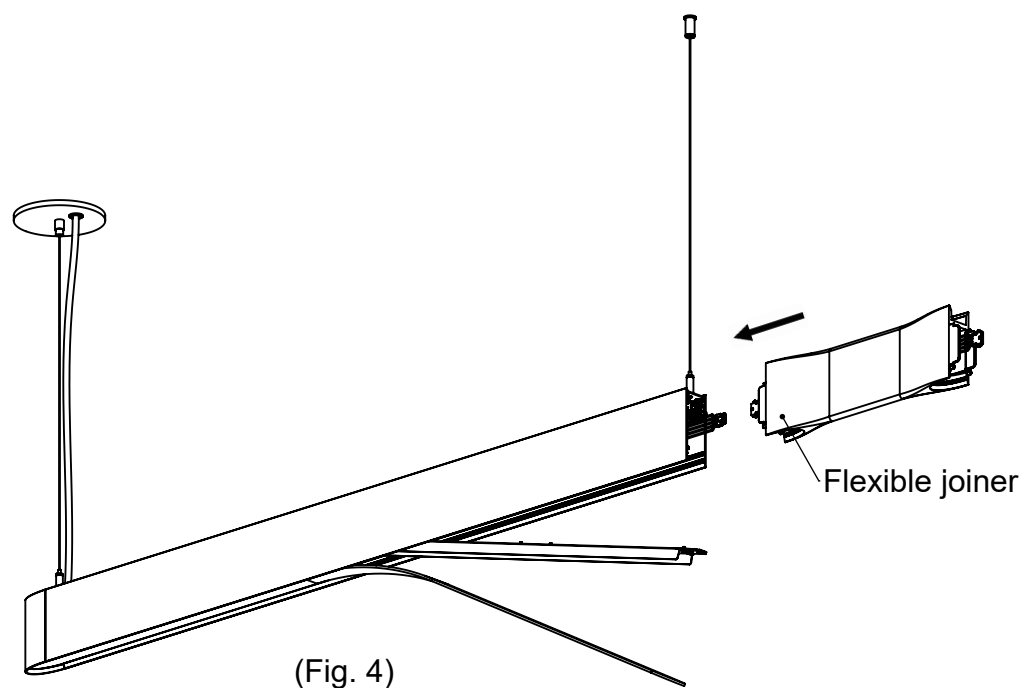

FIXTURE COMES PARTIALLY ASSEMBLED.



Ensure electrical circuit is disconnected before installation.



Luminaires must be installed in accordance with national electrical code and local regulation.

5: Open the latch mechanism and attach it to the hook on the flexible joiner (see Fig. 5).

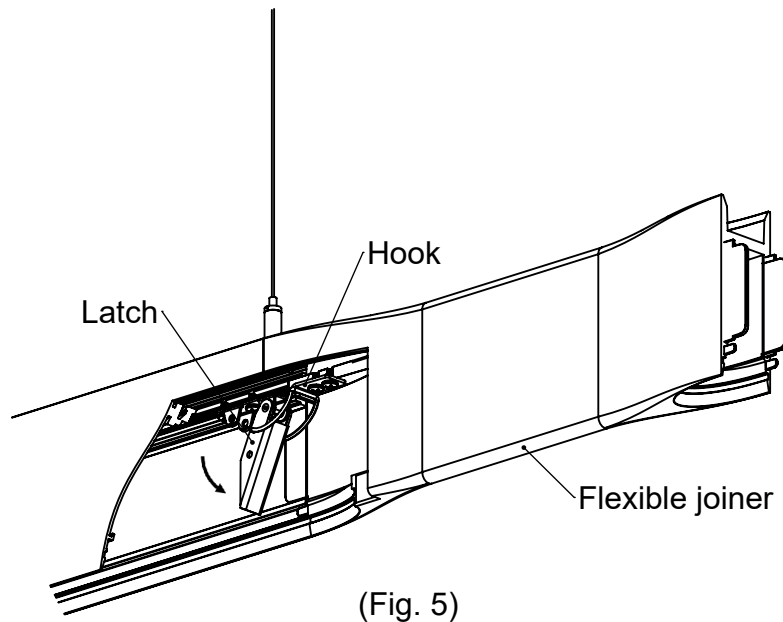

6. Push down the latch to pull the fixture section and the flexible joiner together (see Fig. 6).

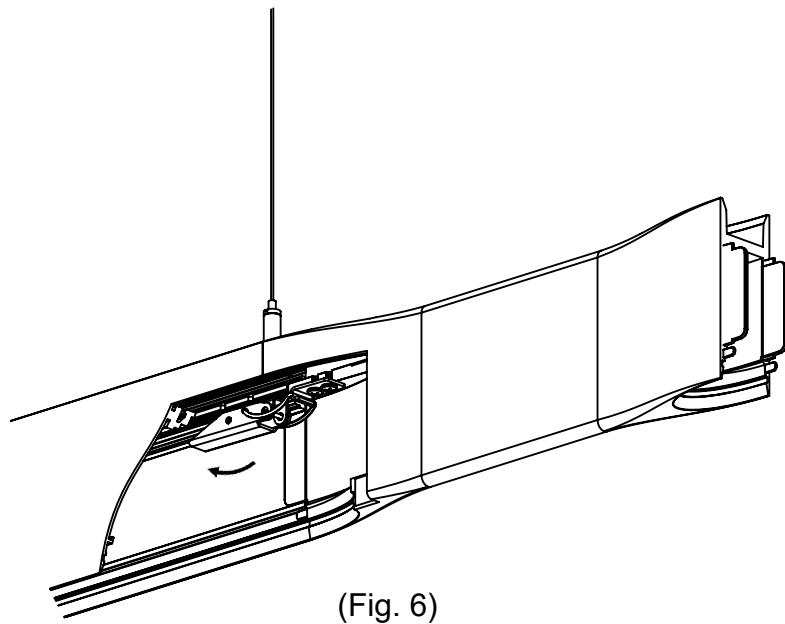

FIXTURE COMES PARTIALLY ASSEMBLED.



Ensure electrical circuit is disconnected before installation.



Luminaires must be installed in accordance with national electrical code and local regulation.

7: Connect the electrical connectors and tuck it behind the LED gear trays (see Fig. 7).

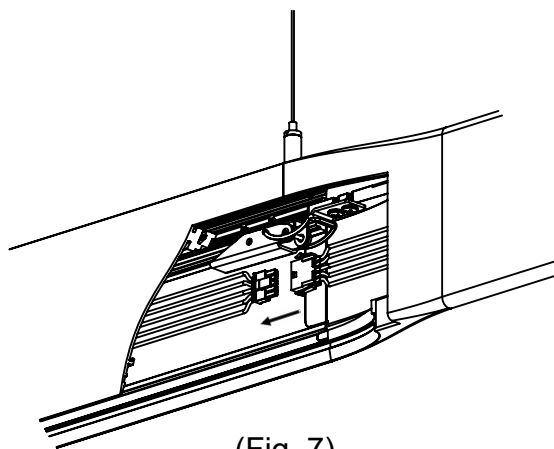

(Fig. 7)

8. Push the LED gear tray back into the fixture. It will snap onto the magnet. Ensure no wires are between the gear tray and the magnet (see Fig. 8).

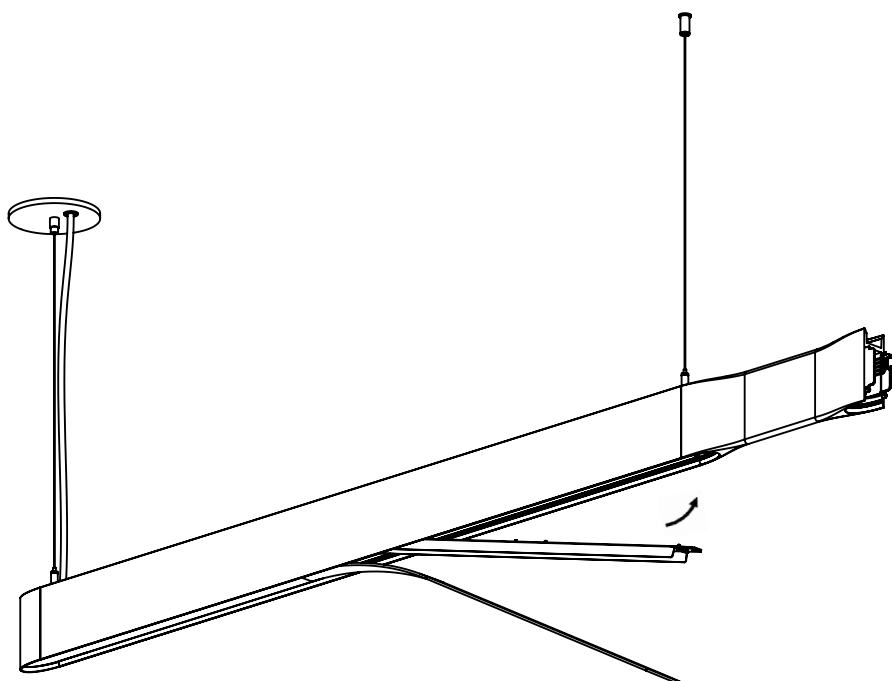

(Fig. 8)

FIXTURE COMES PARTIALLY ASSEMBLED.



Ensure electrical circuit is disconnected before installation.



Luminaires must be installed in accordance with national electrical code and local regulation.

9. Bend the lens so it is pushed into the aluminum extrusion first. Then slide it to the flexible joiner (see Fig. 9).

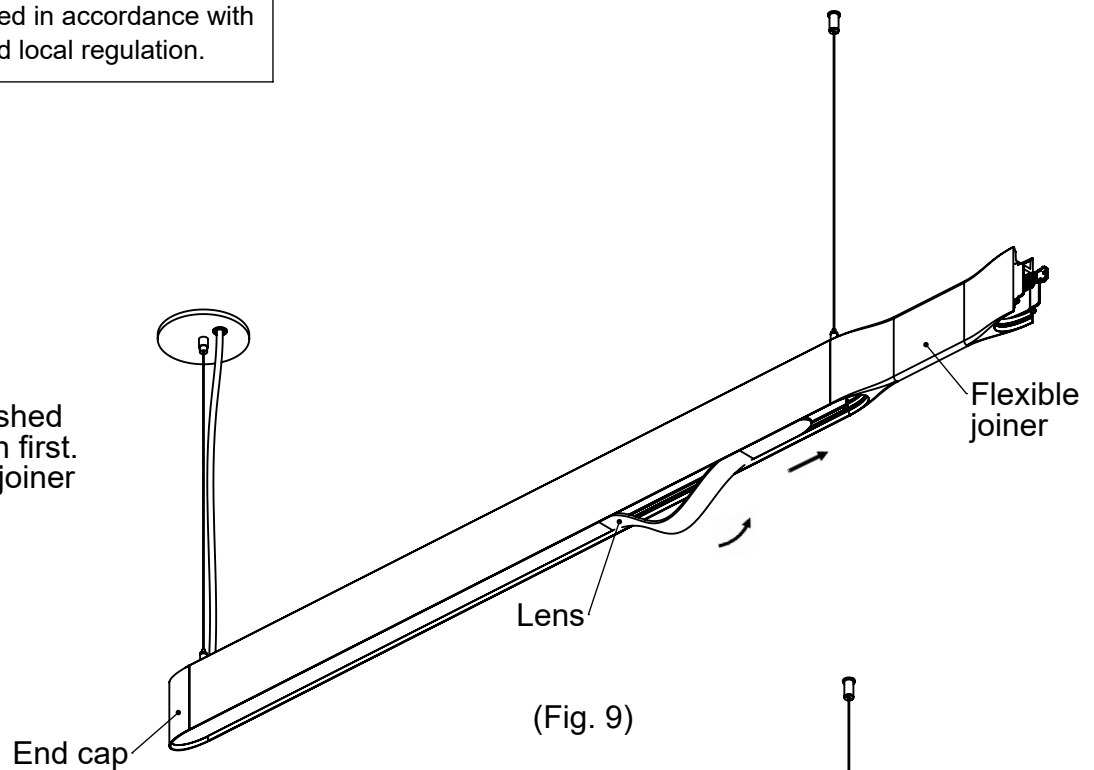

10. If the lens is taken out from the end cap side, follow the same method from step 9. Push the lens into the aluminum extrusion first, then slide it to the end cap (see Fig. 10).

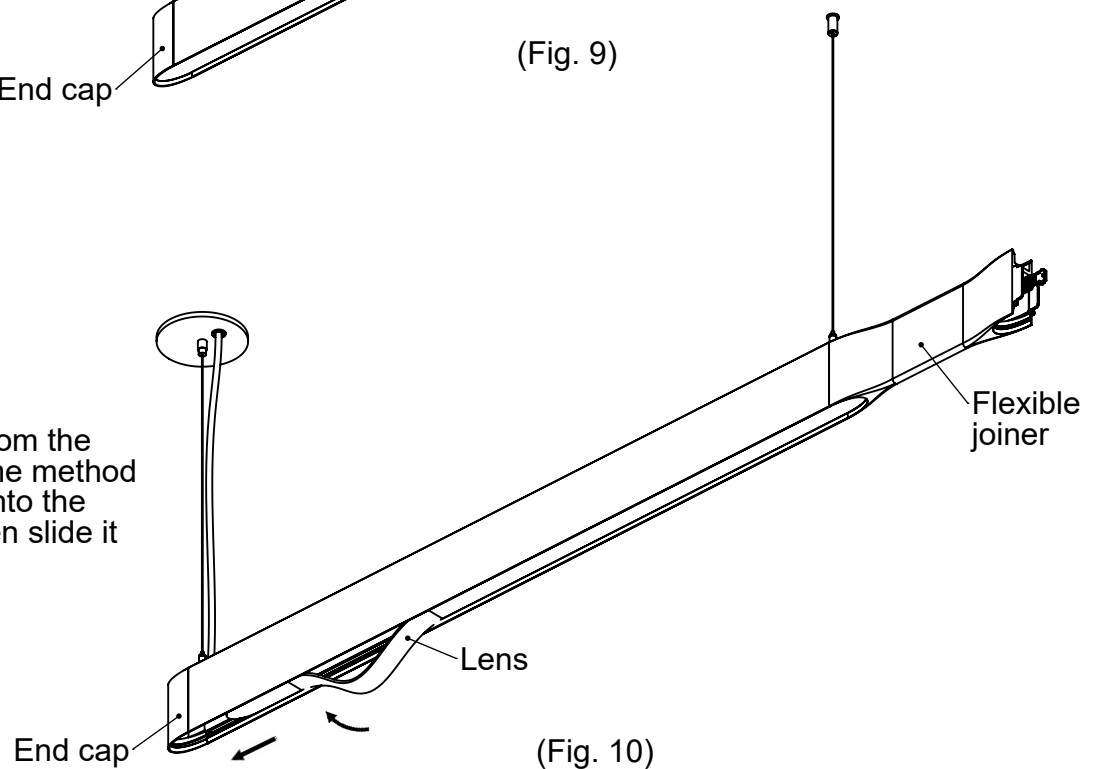

FIXTURE COMES PARTIALLY ASSEMBLED.



Ensure electrical circuit is disconnected before installation.



Luminaires must be installed in accordance with national electrical code and local regulation.

11. Attach the rest of the sections by following the previous steps.

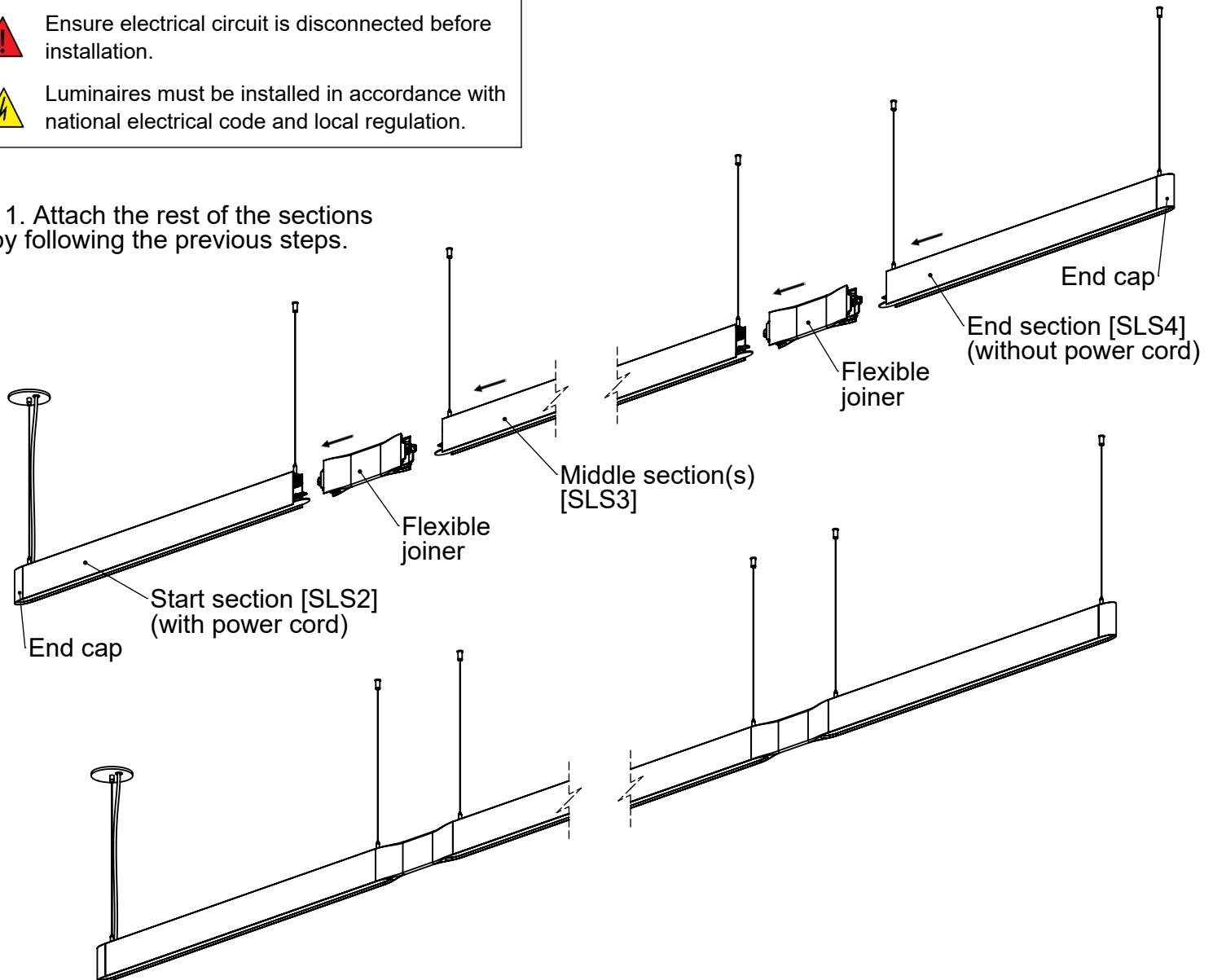

SLS2 - Start section:

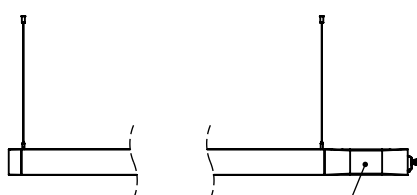

Comes with flexible joiner

SLS3 - Middle section:

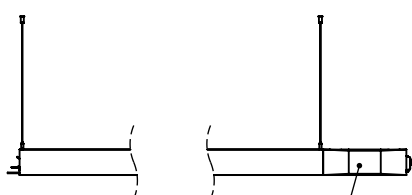

Comes with flexible joiner

SLS4 - End section:

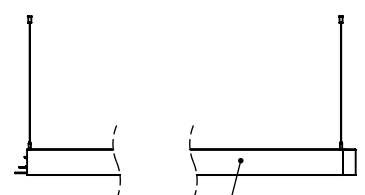

Does not come with flexible joiner