



BOGGLE™

FULL SPECIFICATION SHEET



Fixture Type

Fixture Code

Quantities

1 DESCRIPTION

BOGGLE brings brains and brawn to professional lighting. Miniature downlights assemble into a linear cluster to provide optimum performance with superior optical definition, a 60° cutoff angle, better light efficiency and color rendering, and glare-reducing baffles. Improved color rendering balance, color temperature tunability, and a Unified Glare Rating below 9 make **BOGGLE** especially suitable for workspaces. The curved baffles in black or white present a tailored aesthetic that adds sophistication to the space.

2 MOUNTING & OPTICS



Recessed



Direct

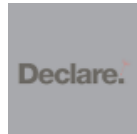

Declare



PoE



Tunable White

3 APPROVALS



4 GENERAL SPECIFICATION

BODY

Aluminum.

BAFFLE

Black or White acrylic.

POE

Can be integrated into your data network via Power over Ethernet (PoE) connectivity.

DRIVERS

HPF electronic drivers for 120–277V, 347V, (EU 240V). The driver is integral to the fixture housing.

INTEGRAL EMERGENCY SYSTEM

Emergency option provides a 1.5 hour (3 hours for EU) emergency lighting facility. The self contained system includes the inverter module, NiCad batteries, LED charge indicator and test switch (NA only). Not available with a 347V supply.

REPORTED L70 @25°C (77°F)

>108000 hrs @1000 lms/ft (3300 lm/m)

DELIVERED LUMENS

Delivered lumens & LPW based on 4000KCRI 90+

DESIGN

US Design Patent Pending.

TUNABLE WHITE

Tunable White range from 2700K to 6500K is available; contact the factory for details.

ESTIMATED L70 @25°C (77°F)

>196000 hrs @1000 lms/ft (3300 lm/m)

APPROVALS

Damp Rated.

5 DESIGN OPTIONS

CEILING TRIM FINISH



Not required



White ¹



Black Metallic Textured ¹

¹ Required for RT4 only.

6 HOW TO ORDER

A. LUMINAIRE

BGGR1R Direct

One power cord for every 50 linear feet.

B. LENGTH OF RUN

SFA_ _ _ _

Order in 2ft increments.

C. MAX LENGTH PER SECTION

SL02 2ft ¹

SL04 4ft

SL06 6ft

SL08 8ft

SL10 10ft

SL12 12ft

¹ Not available with 200 lm/ft.

* You can select the preferred maximum length per segment, to account for transportation and building constraints. Example: If a 40ft run is required and SL12 (12ft) is selected, we would provide 4x 10ft segments. For special requirements, please contact sales@betacalco.com.

D. BAFFLE

BL1 White Baffle (Gloss)

BL2 Black Baffle (Gloss)

BL3 White Baffle (Matte)

BL4 Black Baffle (Matte)

All data shown based on max values, consult Performance Data download for more details.

E. LM/FT

LPF020 200 lm/ft
LPF100 1000 lm/ft

LPF040 400 lm/ft

LPF060 600 lm/ft

LPF080 800 lm/ft

F. CRI

CR90 CRI 90+

G. CCT

CTA27 2700K

CTA30 3000K

CTA35 3500K

CTA40 4000K

CTA60 Tunable White ¹

¹ Tunable White is available with 0-10V dimming options only. Consult factory for details.

H. VOLTAGE

V1 120/277V

V2 240V ¹

V3 347V ²

V4 Low Voltage ³

¹ Not available in North America.

² Only available with DA01 dimming.

³ Only available with DA45 dimming.

I. DIMMING

DA01 0-10V Dimming 1.0%

DA02 0-10V Dimming 0.1% ¹

DA20 DALI Dimming 0.1% ¹

DA21 DALI Dimming 1.0% ¹

DA30 DSI/switchDim ²

DA45 PoE ³

¹ Not available with V3. DALI dimming (DA20 & DA21) not available with CTA60 (Tunable white).

² Not available in North America. Not available with CTA60 (Tunable white).

³ Only available with V4.

J. CEILING TYPE & TRIM

RT1 Tegular T-Bar ¹

RT2 Lay-In T-Bar ¹

RT3 Trimless ³

RT4 Trim ³

¹ Fixture designed to fit into a 9/16" or 15/16" standard tegular grid T-bar and through tile mount. Dimensions are nominal for grid ceiling fixtures. All fixture metalwork is white.

² Fixture designed to fit into a 9/16" or 15/16" standard grid T-bar and through tile mount. Dimensions are nominal for grid ceiling fixtures. All fixture metalwork is white.

³ Fixture designed for drywall ceilings.

K. CEILING TRIM FINISH

FA00 Not required

FA01 White ¹

FA02 Black Metallic Textured ¹

¹ Required for RT4 only.

L. EMERGENCY

E0 Not required

E1 Emergency system – Integral ¹ **E3** Emergency generated circuit – Remote ¹

¹ A drawing will be required at time of ordering to determine the required number and location of the emergency sections or generator circuits. Not available in 347V. Available upon request, consult factory for details.

M. CHICAGO PLENUM

CP0 Not required

CP1 Chicago Plenum ¹

7 TECHNICAL DATA

LUMINAIRE

One power cord for every 50 linear feet.

Code **BGGR1R**
Light Direction Direct

8 PERFORMANCE DATA

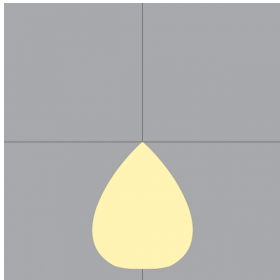
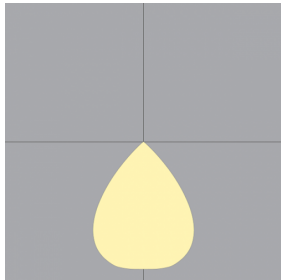
DIRECT WHITE BAFFLE	LUMEN/FT	WATT/FT	LPW	DIRECT BLACK BAFFLE	LUMEN/FT	WATT/FT	LPW
	1000	11	90		1000	11	85
	800	9	92		800	9	87
	600	6	96		600	6	91
	400	4	101		400	4	96
	200	2	107		200	2	101

9 TM-30 DATA

CCT 2700K

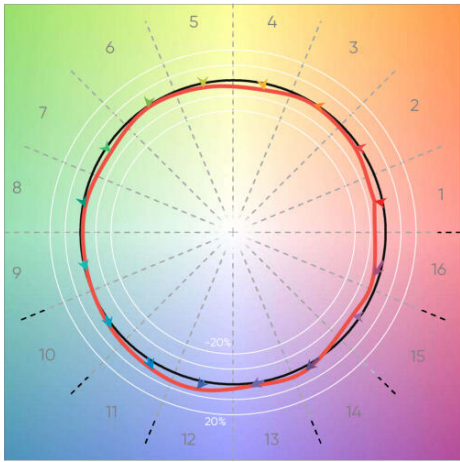

CRI (Ra)	93
CRI (R9)	61
TM30 Rf	91
TM30 Rg	98
Duv	-0.0022

CCT 3000K

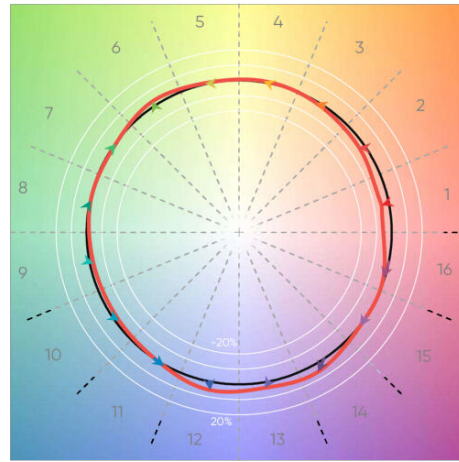

CRI (Ra)	92
CRI (R9)	58
TM30 Rf	92
TM30 Rg	100
Duv	-0.0003

CCT 3500K

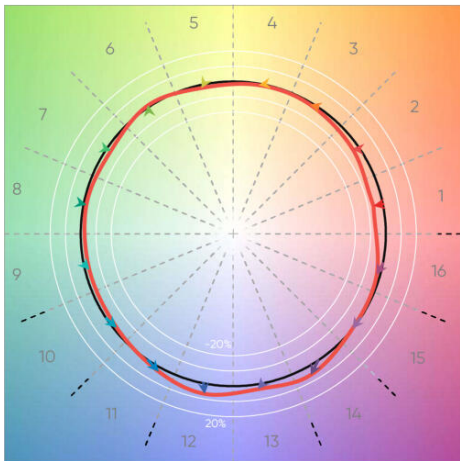

CRI (Ra)	91
CRI (R9)	53
TM30 Rf	90
TM30 Rg	99
Duv	-0.0007

CCT 4000K

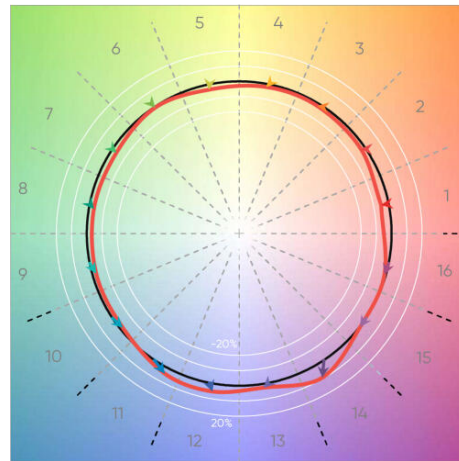

CRI (Ra)	93
CRI (R9)	64
TM30 Rf	90
TM30 Rg	98
Duv	0.0000

ISOMETRIC BOTTOM VIEW
HARD CEILING

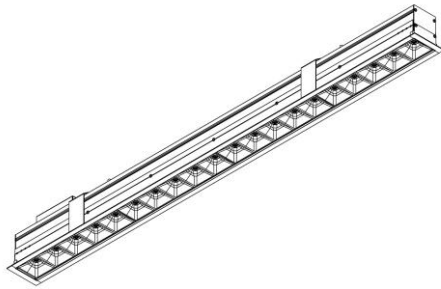

ISOMETRIC BOTTOM VIEW
GRID CEILING

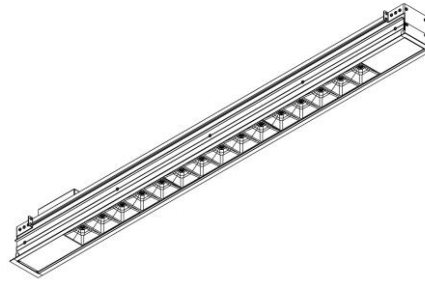

Grid Ceiling - Tegular ceiling

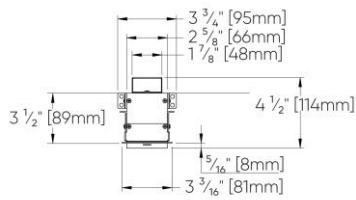
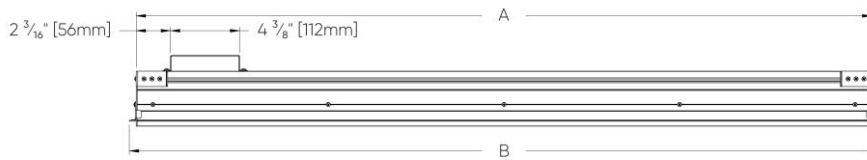

Max Length (Per section)	A	B
2ft	22 13/16" [580mm]	23 11/16" [602mm]
4ft	46 13/16" [1189mm]	47 11/16" [1212mm]
6ft	70 13/16" [1791mm]	71 11/16" [1821mm]
8ft	94 13/16" [2408mm]	95 11/16" [2431mm]
10ft	118 13/16" [3018mm]	119 11/16" [3040mm]
12ft	142 13/16" [3627mm]	143 11/16" [3650mm]

Grid Ceiling - T-bar ceiling

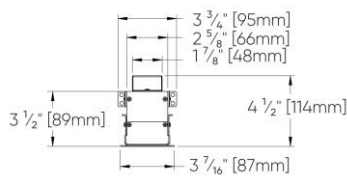
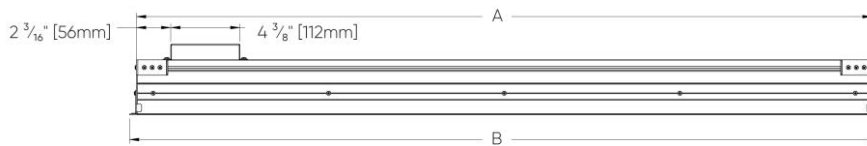

Max Length (Per section)	A	B
2ft	22 13/16" [580mm]	23 11/16" [602mm]
4ft	46 13/16" [1189mm]	47 11/16" [1212mm]
6ft	70 13/16" [1791mm]	71 11/16" [1821mm]
8ft	94 13/16" [2408mm]	95 11/16" [2431mm]
10ft	118 13/16" [3018mm]	119 11/16" [3040mm]
12ft	142 13/16" [3627mm]	143 11/16" [3650mm]

Hard Ceiling – Trimless

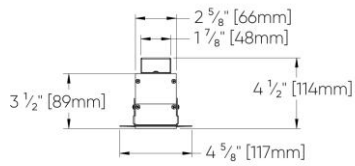
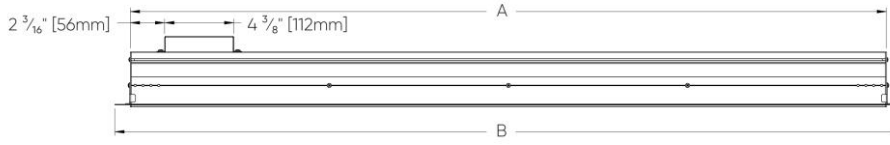

Max Length (Per section)	A	B
2ft	24 1/8" [612mm]	26 1/8" [663mm]
4ft	48 1/8" [1222mm]	50 1/8" [1273mm]
6ft	72 1/8" [1831mm]	74 1/8" [1882mm]
8ft	96 1/8" [2431mm]	98 1/8" [2492mm]
10ft	120 1/8" [3050mm]	122 1/8" [3040mm]
12ft	144 1/8" [3660mm]	146 1/8" [3711mm]

Hard Ceiling – Trim

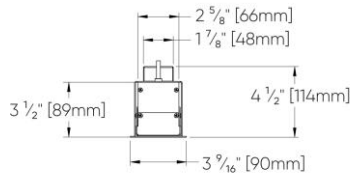
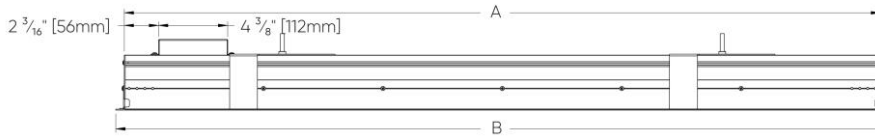

Max Length (Per section)	A	B
2ft	24 1/8" [612mm]	26 1/8" [663mm]
4ft	48 1/8" [1222mm]	50 1/8" [1273mm]
6ft	72 1/8" [1831mm]	74 1/8" [1882mm]
8ft	96 1/8" [2431mm]	98 1/8" [2492mm]
10ft	120 1/8" [3050mm]	122 1/8" [3040mm]
12ft	144 1/8" [3660mm]	146 1/8" [3711mm]