

MATREX SINGLE™ - SURFACE

Project Name:

Fixture Type:

Fixture Code:

Quantities:



MATREX SINGLE™ - SURFACE

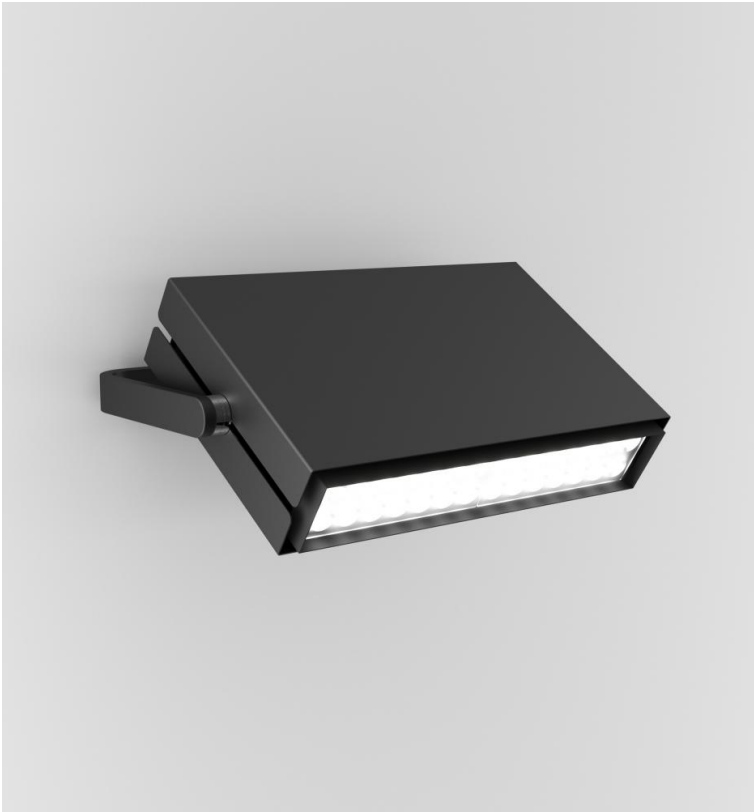

MATREX SINGLE™ - SURFACE

MATREX is a family of spotlights packed with power for projecting light at great distances. With best-in-class thermal management and hidden heat sinks, MATREX's form factor is significantly smaller than traditional spotlights. Multiple mounting systems are available, providing a variety of functions that work in a range of applications, especially those with multiple ceiling heights.

GENERAL SPECIFICATION

Body and trim

Steel and aluminum.

Drivers

HPF, electronic, 120-277V, 347V (EU-240V). The driver is integral to the fixture housing.

Remote emergency system (North America only)

Emergency option provides a 1.5 hour emergency lighting facility. The remote system includes the inverter module, NiCad batteries and a remote wall/ceiling LED charge indicator and test switch (maximum distance between wall/ceiling plate and luminaire is 4.5m/15'). Test switch fits a single gang box (not supplied).

Reported L70 @25°C (77°F)

> 60,000 hrs.

Sensors

Consult factory regarding sensor compatibility.

Designed by

Serge Cornelissen.

Finish

Powder coated as specified. Custom paint finishes available to special order.

Delivered lumens

Delivered lumens & lpm based on 4000K, CRI 80+.

Mechanical

Luminaires mount to a junction box or switch box (by others - North America only), depending on canopy selection.

Estimated L70 @25°C (77°F)

> 171,000 hrs.

Approvals

Damp Rated.

Design

US Pat. No. D917,765.

MOUNTING & OPTICS

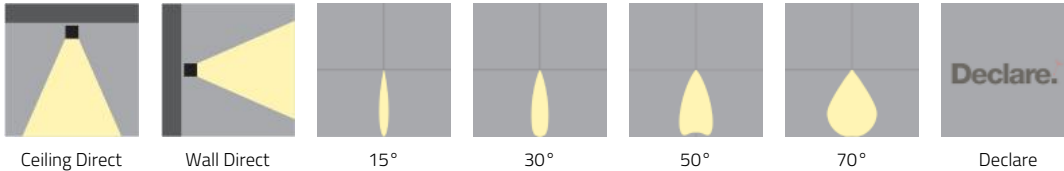

MATREX SINGLE™ - SURFACE

HOW TO ORDER

A. LUMINAIRE

MATF1P01 Direct, 9200 lms

All data shown at max output and nominal values.

B. LUMENS

LMA0230 2300

LMA0460 4600

LMA0690 6900

LMA0920 9200

* Max lumen values shown, refer to IES files for the different snoot and beam options.

C. CRI

CR80 CRI 80+

CR90 CRI 90+

D. CCT

CTA27 2700K¹

CTA30 3000K

CTA35 3500K

CTA40 4000K

¹ 2700K is only available with CRI 80+

E. BEAM ANGLE

BA15 15°

BA30 30°

BA50 50°

BA70 70°

BA80 50°x80°¹

¹ For use with NT8 Ladder Louver only.

F. VOLTAGE

V1 120/277V

V2 240V¹

V3 347V²

¹ Not available in North America.

² Only available with DA01 dimming.

G. DIMMING

DA01 0-10V Dimming 1.0%

DA02 0-10V Dimming 0.1%¹

DA20 DALI Dimming 0.1%¹

DA21 DALI Dimming 1.0%¹

DA30 DSI/switchDim^{1 2}

¹ Not available with V3.

² Not available in North America.

H. FIXTURE FINISH

FA01 White

FA02 Black Metallic - Textured

FA20 Silver Metallic - Textured

FA25 Gold Metallic - Textured

FA44 Midnight Blue Metallic - Textured

FA46 Charcoal Metallic - Textured

FA47 Bronze Metallic - Textured

FA53 Red Metallic - Textured

I. SNOOTS AND LOUVERS

NT1 Standard Snoot - Black¹

NT2 Standard Snoot - White¹

NT3 Long Snoot - Black¹

NT4 Long Snoot - White¹

NT7 Hex Louver - Black²

NT8 Ladder Louver - Black³

For precise beam angle and lumen output, please refer to the IES files. Note that using snoots and louvers may decrease overall efficacy.

¹ A snoot must be picked at time of order, if you are not ordering a louver.

² Not available with BA70 beam angle.

³ Available with BA80 beam angle and 2300 lumens.



MATREX SINGLE™ - SURFACE

J. EMERGENCY

E0 Emergency system not required

E2 Emergency system - Remote ¹

¹ Not available with V3. Integral not available.



MATREX SINGLE™ - SURFACE

TECHNICAL DATA

LUMINAIRE

All data shown at max output and nominal values.

Code	MATF1P01
Light Direction	Direct
Wattage	82
Delivered lms	9200
LPW	130

FINISH - FIXTURE



APPROVALS



MATREX SINGLE™ - SURFACE

PERFORMANCE DATA

DIRECT 15° BEAM ANGLE

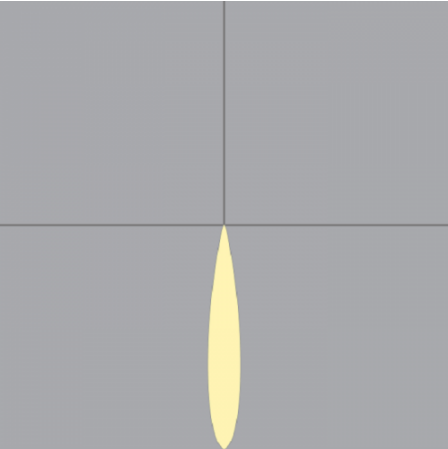

WATTS
16
36
57
82

LUMENS
2300
4500
6800
9000

LPW
138
127
118
110

DIRECT 30° BEAM ANGLE

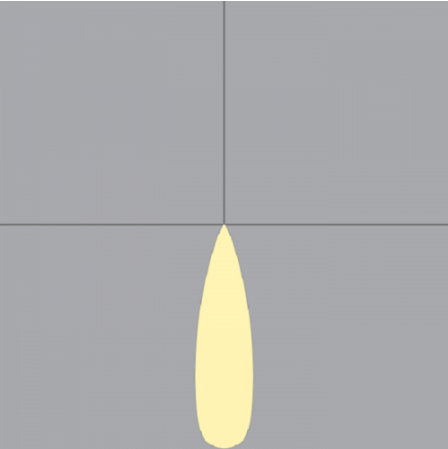

WATTS
16
36
57
82

LUMENS
2300
4600
6900
9200

LPW
140
130
120
112

DIRECT 50° BEAM ANGLE

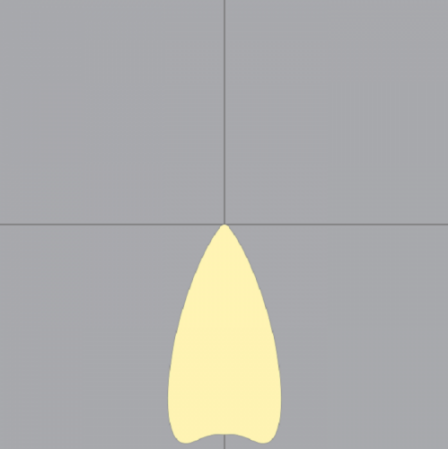

WATTS
16
36
57
82

LUMENS
2200
4400
6500
8700

LPW
133
123
114
107

MATREX SINGLE™ - SURFACE

DIRECT 70° BEAM ANGLE

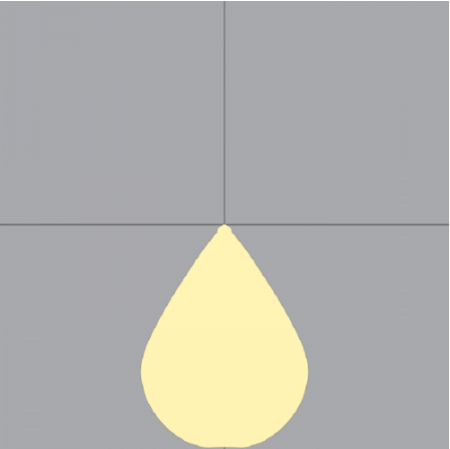

WATTS
16
36
57
82

LUMENS
2200
4400
6600
8800

LPW
134
123
115
107

MATREX SINGLE™ - SURFACE

DIMENSIONAL DIAGRAMS

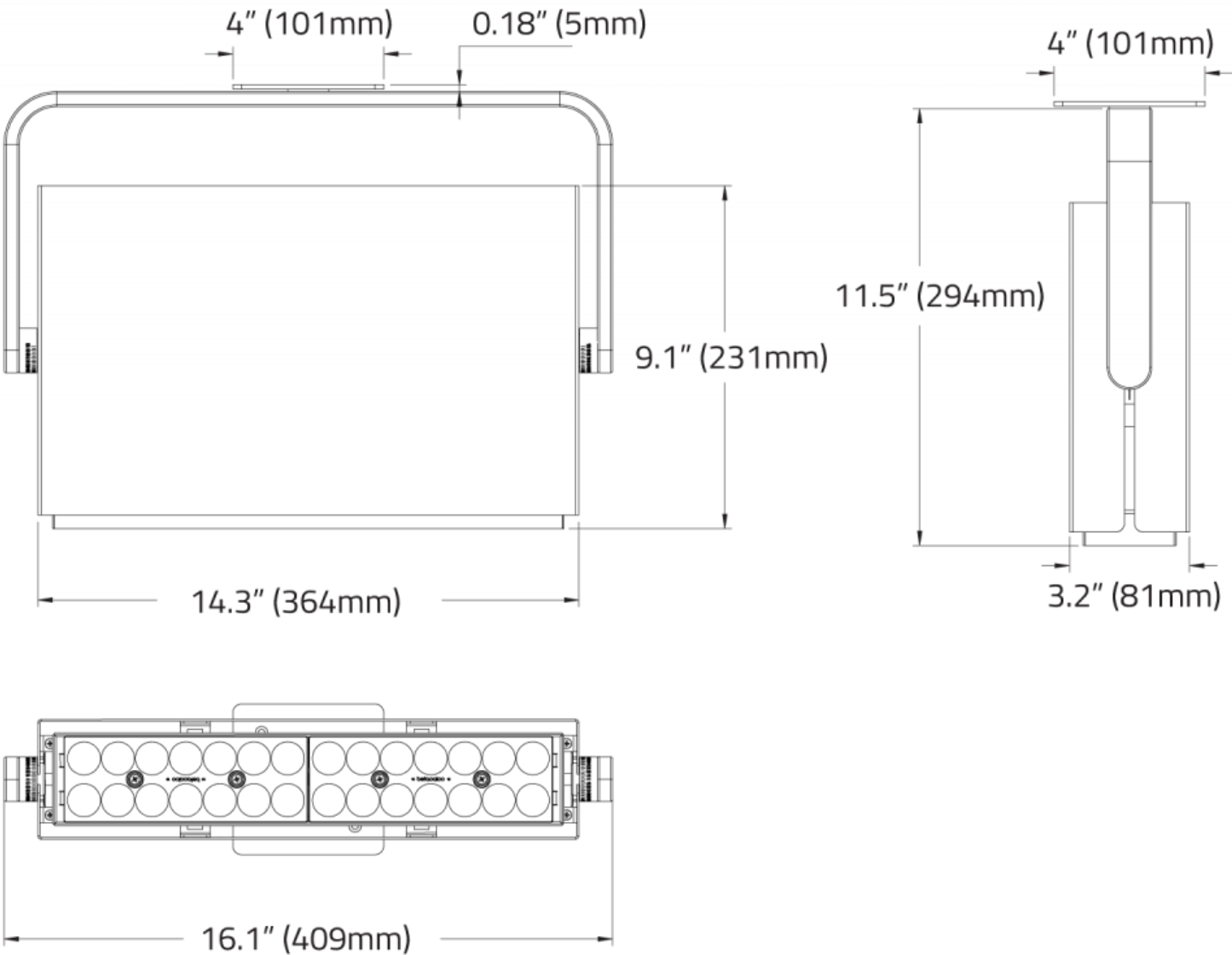

MATREX SINGLE™ - SURFACE

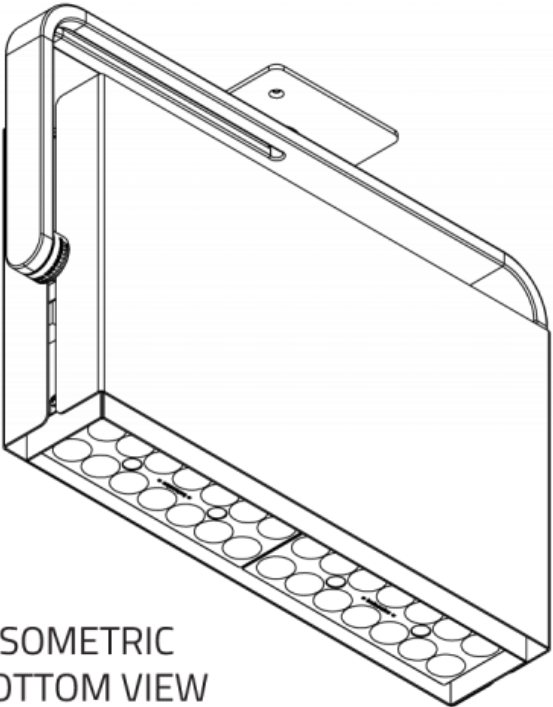
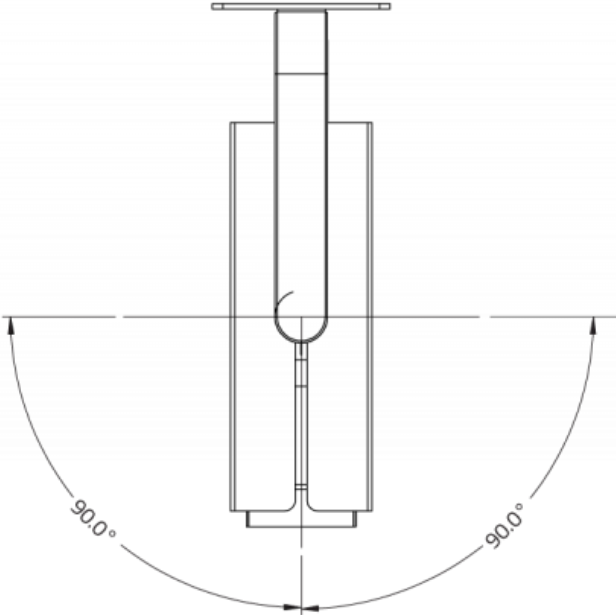

ISOMETRIC
BOTTOM VIEW

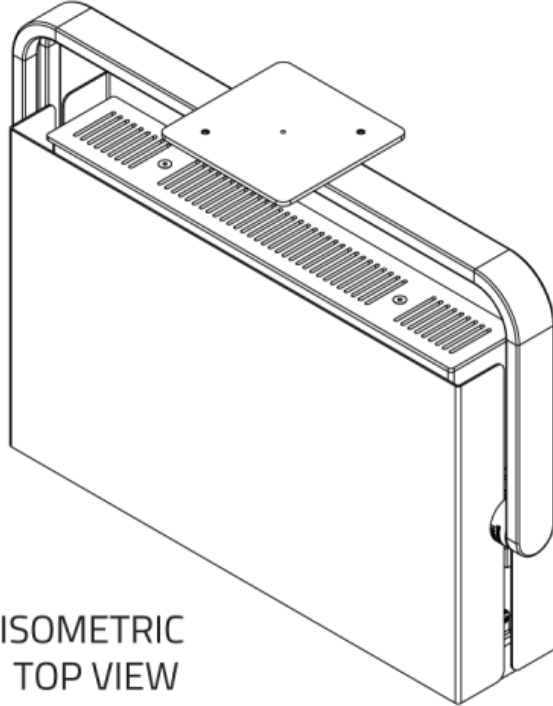
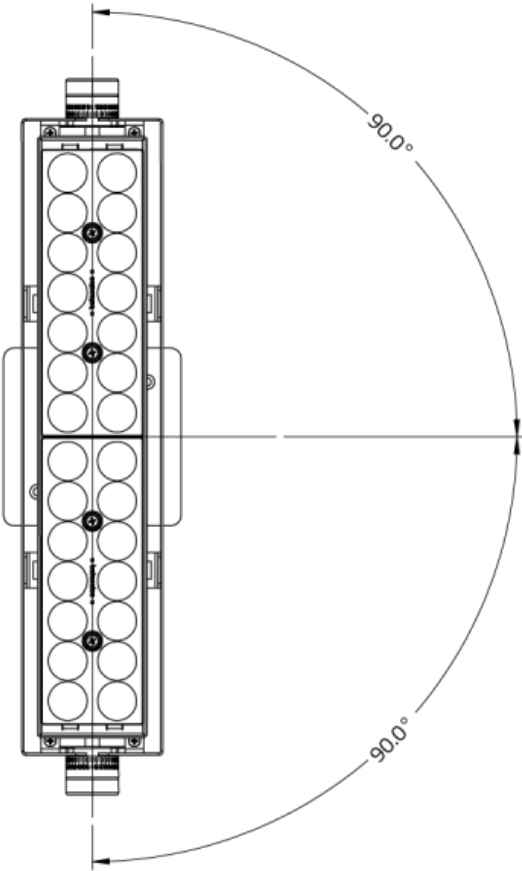

ISOMETRIC
TOP VIEW

MATREX SINGLE™ - SURFACE

LOUVRES

HEX CELL LOUVRE

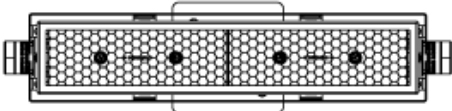
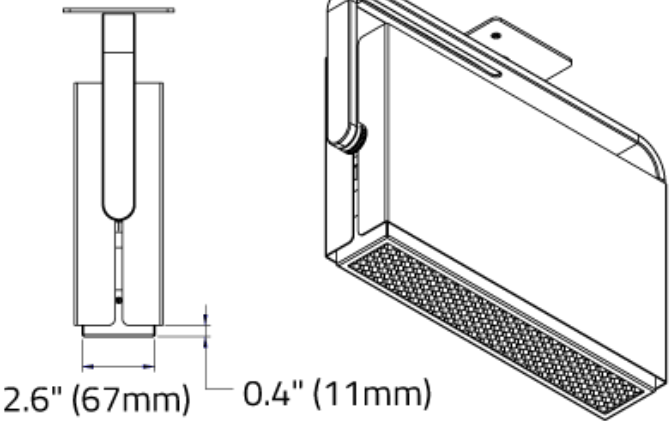
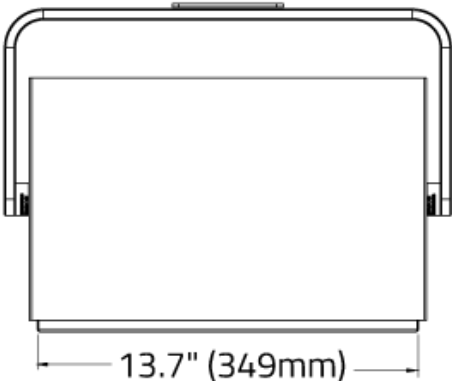

LADDER LOUVRE

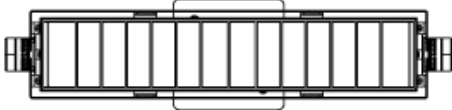
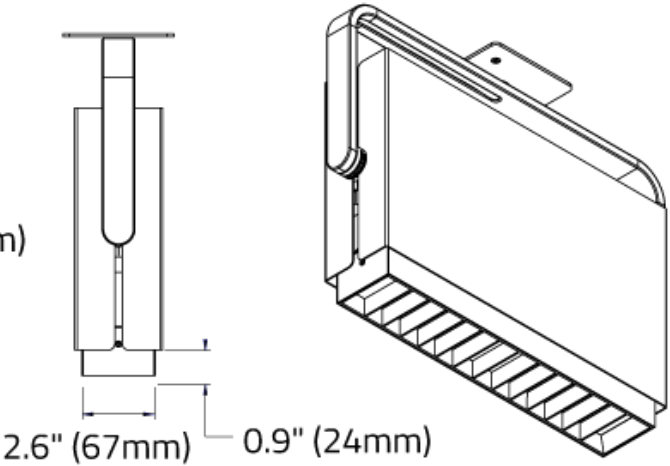
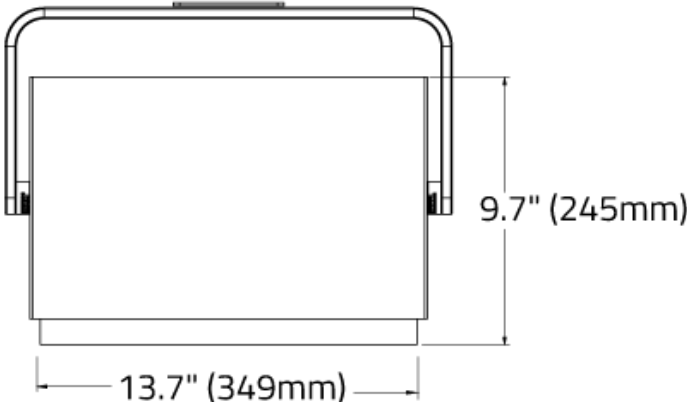

MATREX SINGLE™ - SURFACE

SNOOTS

STANDARD SNOOT

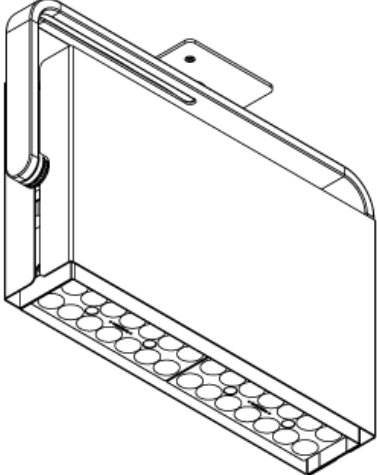
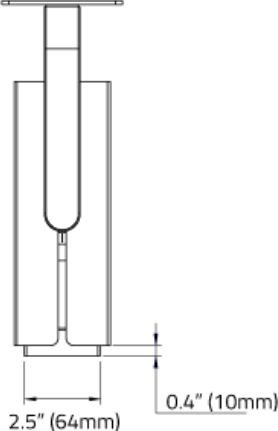
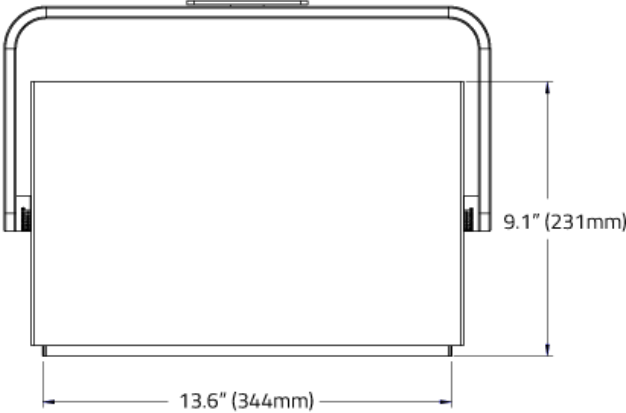

LONG SNOOT

